



# Bathurst Quay Streetscape & Public Realm: Taxi Corral + Parking Improvements

Schematic Design  
April 24<sup>th</sup>, 2019

## Project Description & Background

- From late 2014-2017, City of Toronto conducted a series of consultations to create a neighbourhood plan for Bathurst Quay.
- Following City Council's endorsement of the Bathurst Quay Neighbourhood Plan, City of Toronto Waterfront Secretariat engaged consultants to prepare schematic designs for near-term improvements to five focus areas within BQNP study area.

### Key Dates:

- July 4, 2017: City Council Endorsed the Bathurst Quay Neighbourhood Plan Interim Report
- June, 2018: City Council approved the Bathurst Quay Neighbourhood Plan through an Official Plan Amendment (SASP 189)
- March 2019: Taxi corral and parking area Site Plan Approval application
- 2019/ 2020: Detailed design for pedestrian plaza and path + WTDRP
- 2019/ 2020: Phased construction to begin

## Project Description & Background

- From late 2014-2017, City of Toronto conducted a series of consultations to create a neighbourhood plan for Bathurst Quay.
- July 4, 2017: City Council Endorsed the Bathurst Quay Neighbourhood Plan Interim Report

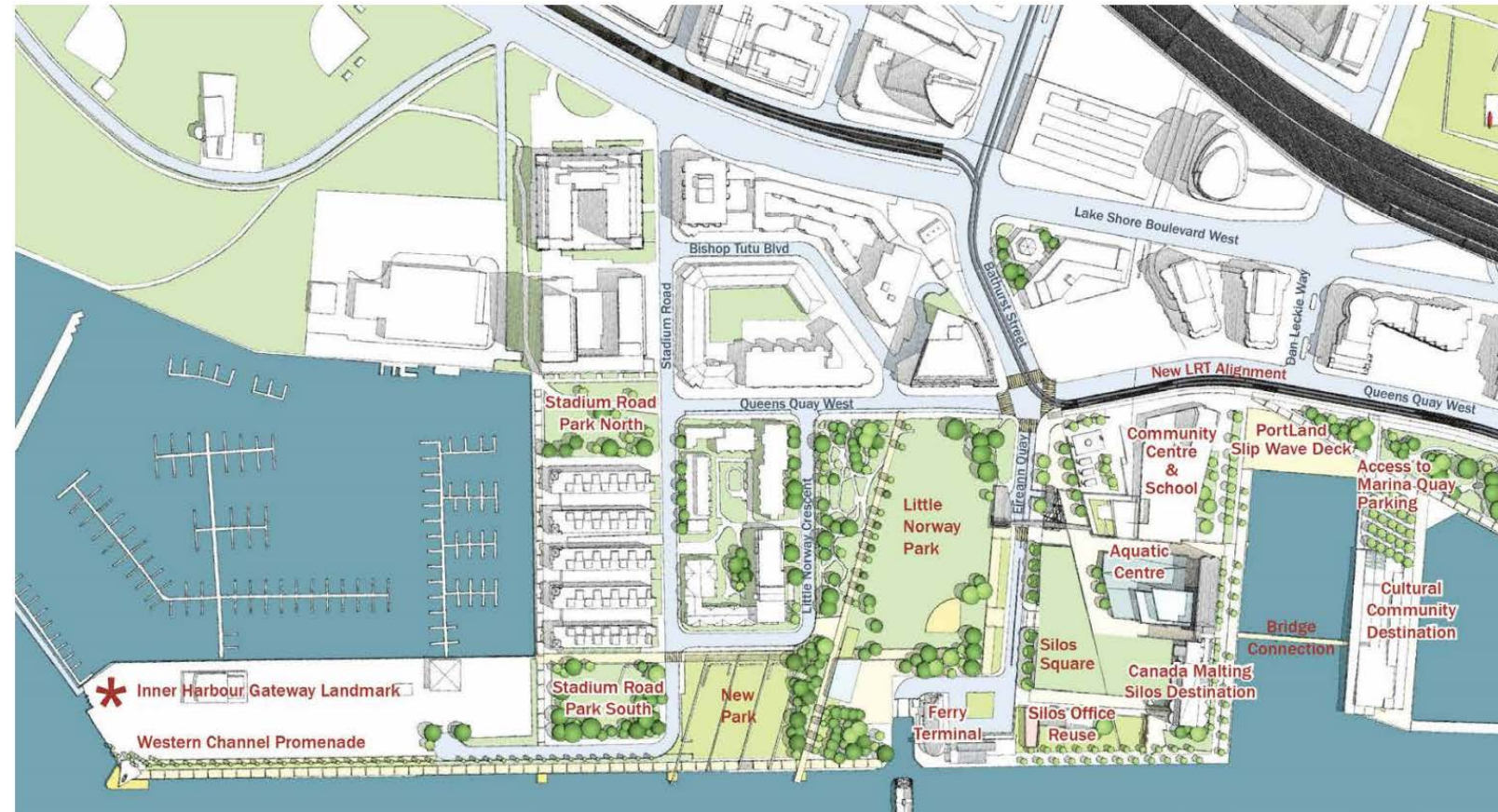

Demonstration Plan – Nov. 2016

## Bathurst Quay Neighborhood Plan

- The BQNP describes a new long-term vision for the silo site as a community and cultural hub on the waterfront, and potential future location of an aquatic centre.
- In the near term, the BQNP recommends creating a streetscape and public realm improvement plan to identify 'quick start' improvements to existing conditions.

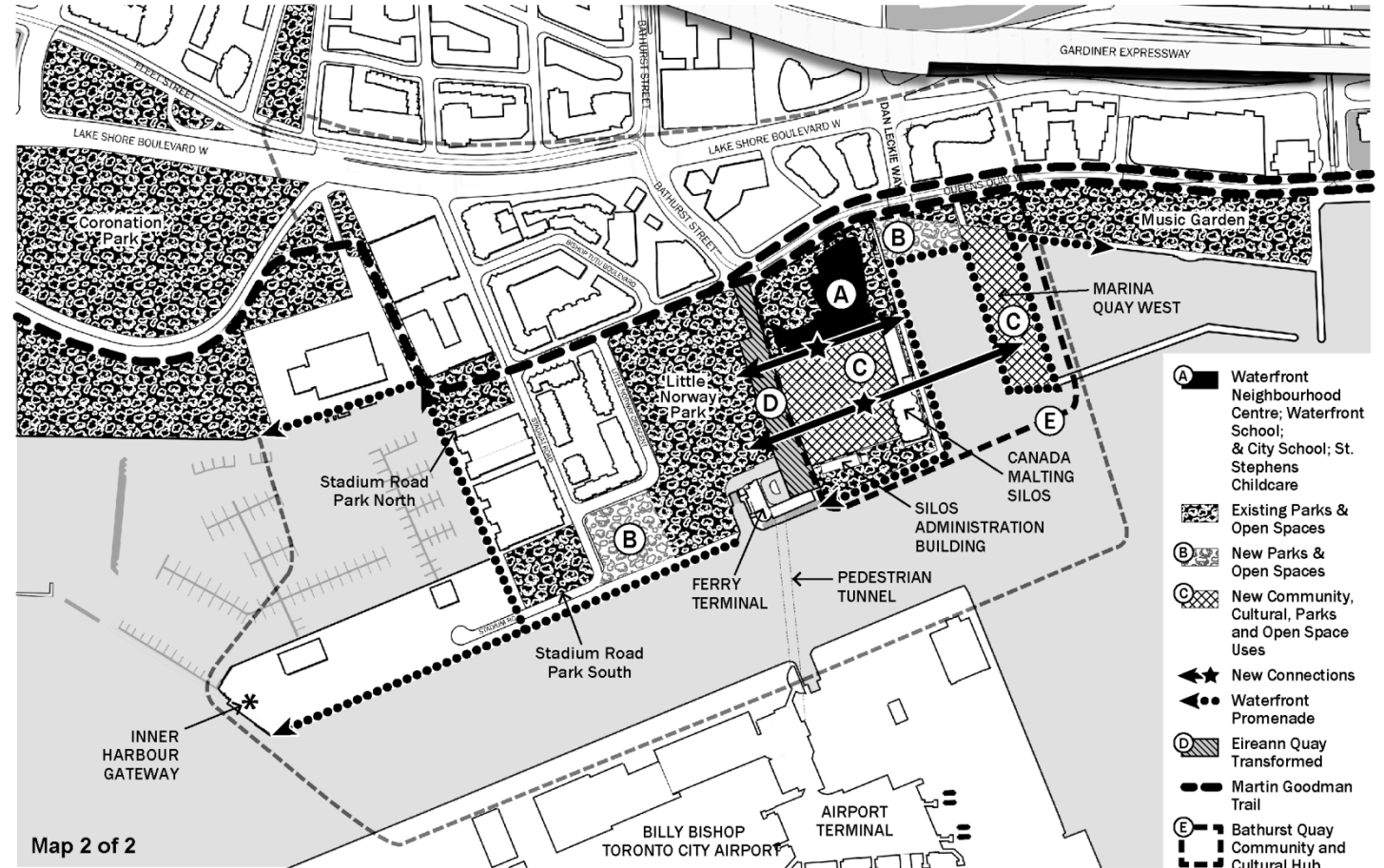

Map 2 - Bathurst Quay Framework Plan

Framework Plan as per the approved Official Plan Amendment (SASO 189) – June 2018

# Policy Context – Central Waterfront Secondary Plan

(P5) Waterfront streets will be remade as “places” with distinct identities. Streets will act as lively urban connections as well as traffic arteries. The needs of motorists will be balanced with efficient transit service and high-quality amenities for pedestrians and cyclists.

## B7\_RESERVING THE WATER’S EDGE FOR PUBLIC USE

B17\_CANADA MALTING, A LANDMARK SITE AND SPECIAL PLACE The Canada Malting Silos, a landmark and important heritage feature on the Central Waterfront, will be retained and improved. The City will pursue innovative proposals for a mix of public and private activities and uses that can successfully transform the silos building into a unique special place on the Toronto waterfront.

(P10) The design of the public realm will be of a standard of excellence characteristic of the great city waterfronts of the world.

(P11) The public realm will be defined by a coherent framework of streets, parks, plazas, buildings, viewing areas, walkways, boardwalks, promenades, piers, bridges and other public infrastructure and open space elements.

# Site Context - Transit

## Bathurst Quay Streetscape & Public Realm

Proponent: City of Toronto

Design Team: DILLON/Montgomery Sisam

Review Stage: Schematic Design

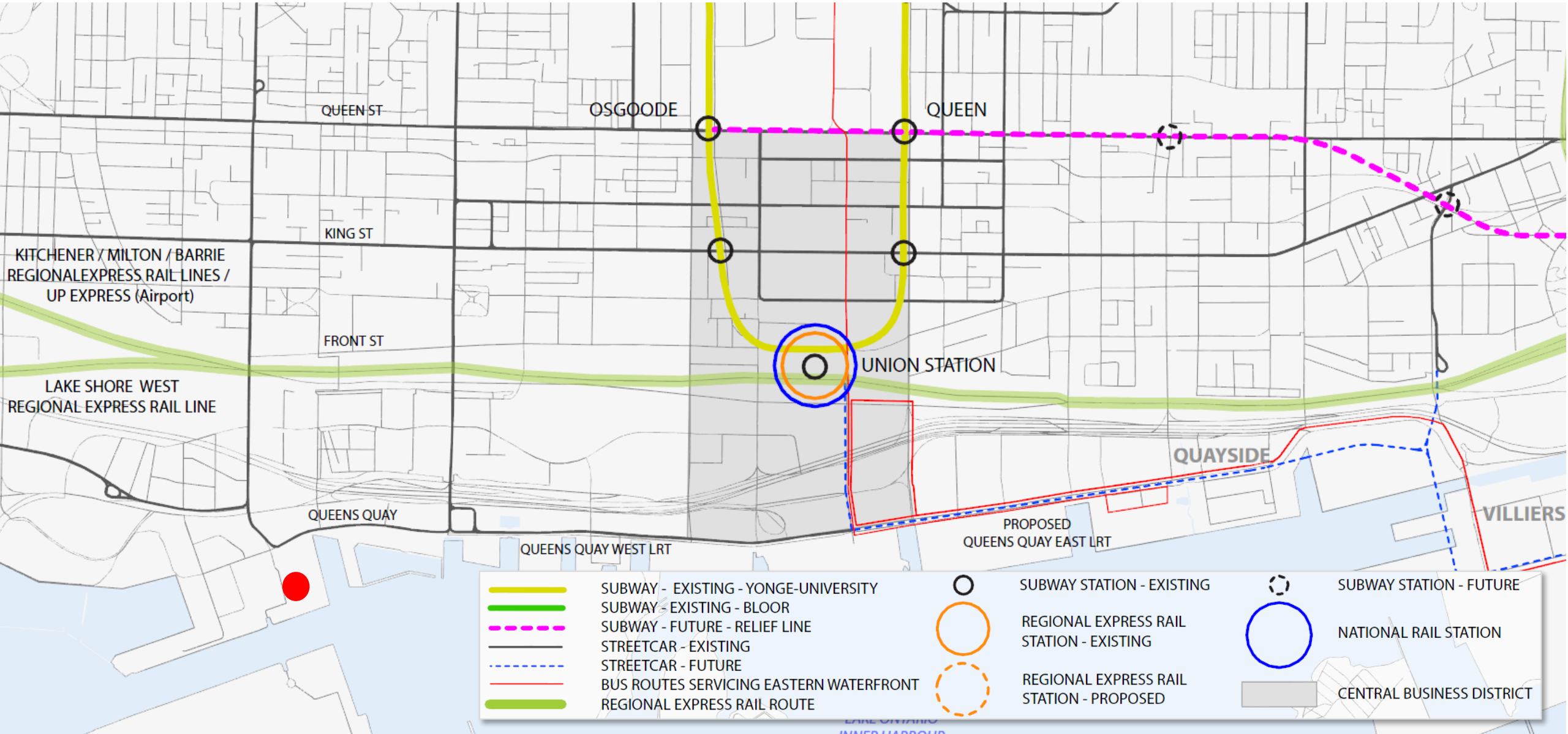

# Site Context – Transit

## Bathurst Quay Streetscape & Public Realm

Proponent: City of Toronto

Design Team: DILLON/Montgomery Sisam

Review Stage: Schematic Design

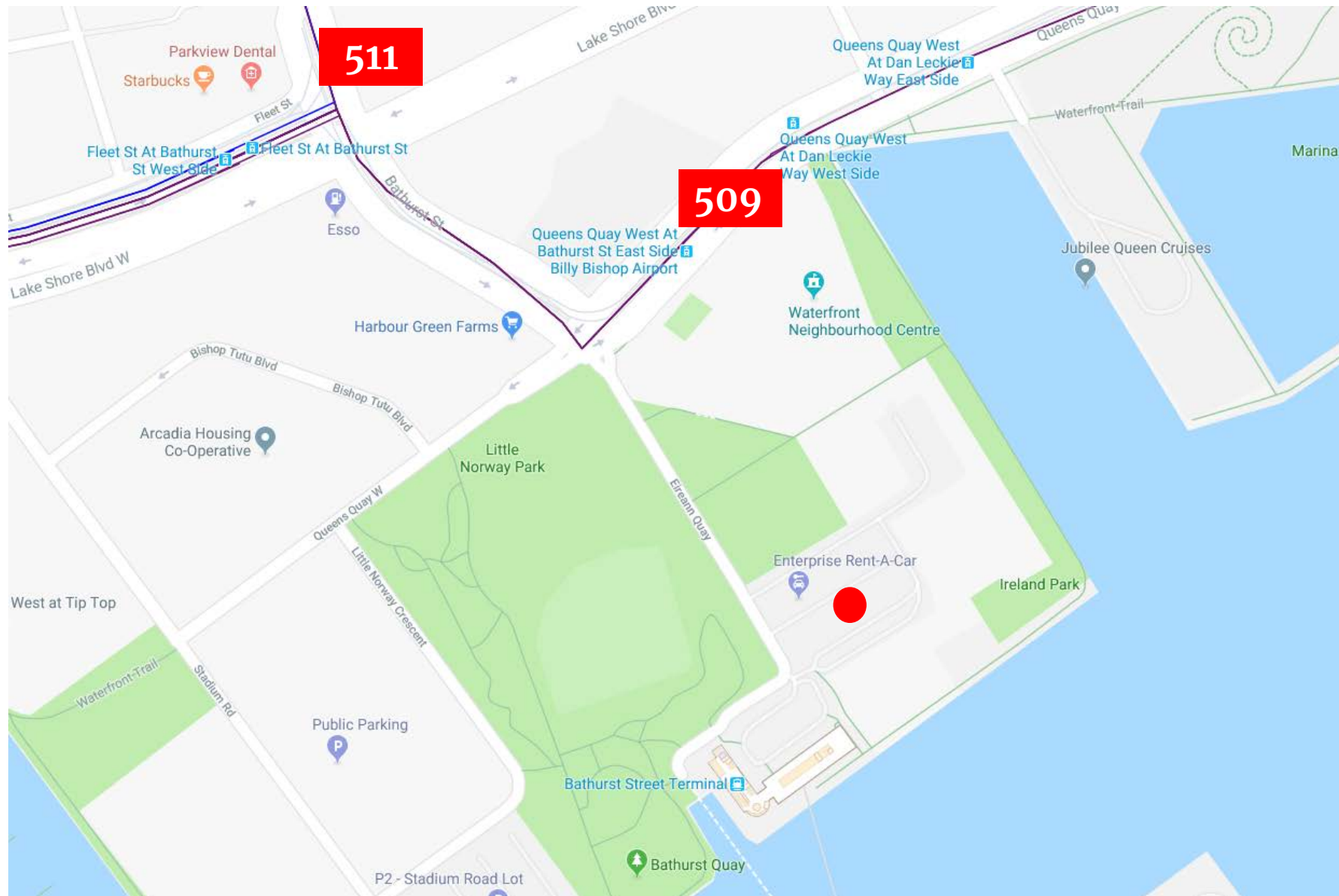

# Project Approval Stage

## DRP Stream 2: Private land – Site Plan Approval

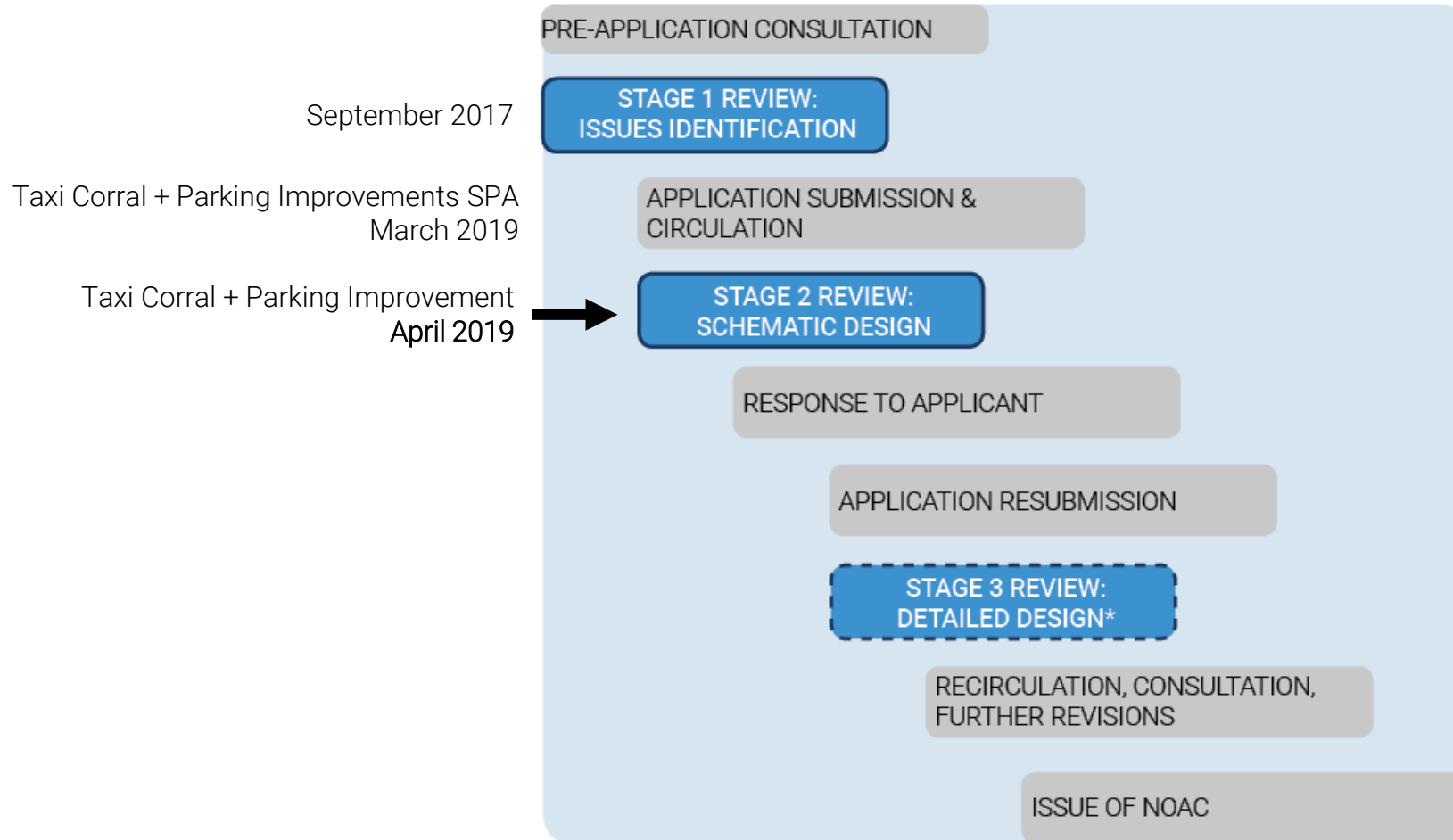



# Recap from September 2017

## Issues Identification - Panel Consensus Comments

- The long-term vision needs to be clearly set out at the next meeting
- Extending the streetcar service to the airport should be a consideration
- Consider piloting small projects that help improve air quality
- Reconsider the focal point of the site from the centre of the site to the water's edge promenade

# Areas for Panel Consideration

- Does the design of the current scope support the long-term vision of Bathurst Quay?
- Do they initial steps begin to activate the site in relation to the creation of the public plaza and new uses in the administration building?
- Does the design support Waterfront Toronto's mandate of a vibrant public realm that will integrate future plaza, pedestrian path, water's edge promenade, and revitalization of the Canada Malting Silos and the Ports Toronto Admin building?
- Does the design of the new canopy structure, taxi corral and parking area design support Waterfront Toronto's objectives of design excellence and sustainability?
- Has the team adequately addressed site access, pedestrian and vehicular flow in relation to the greater plaza?

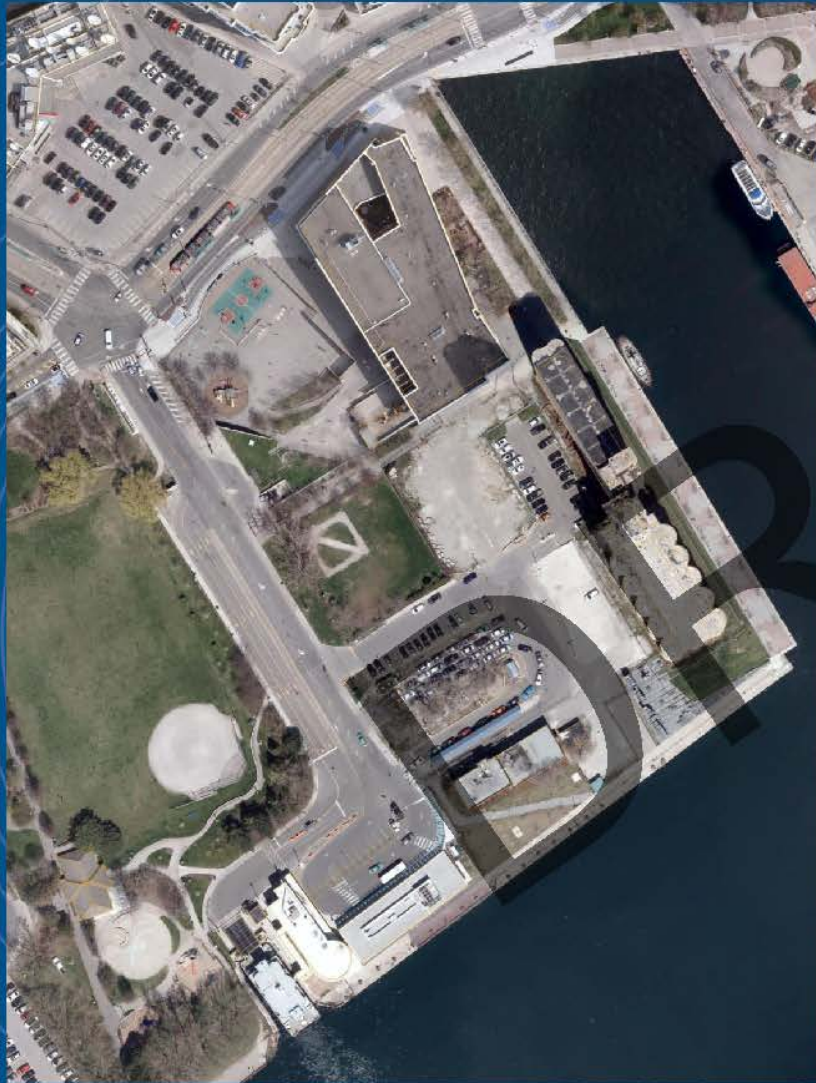

# BATHURST QUAY STREETSCAPE & PUBLIC REALM IMPROVEMENT PLAN

Ports Toronto Site Plan Control Application  
for Enabling Transportation Works

Waterfront Toronto  
Design Review Panel

April 24, 2019

# Presentation overview

Overview of BQNP &  
Streetscape & Public Realm  
Improvement Plan

Project phases & updates

Current PortsToronto  
Site Plan Control Application

Questions / comments

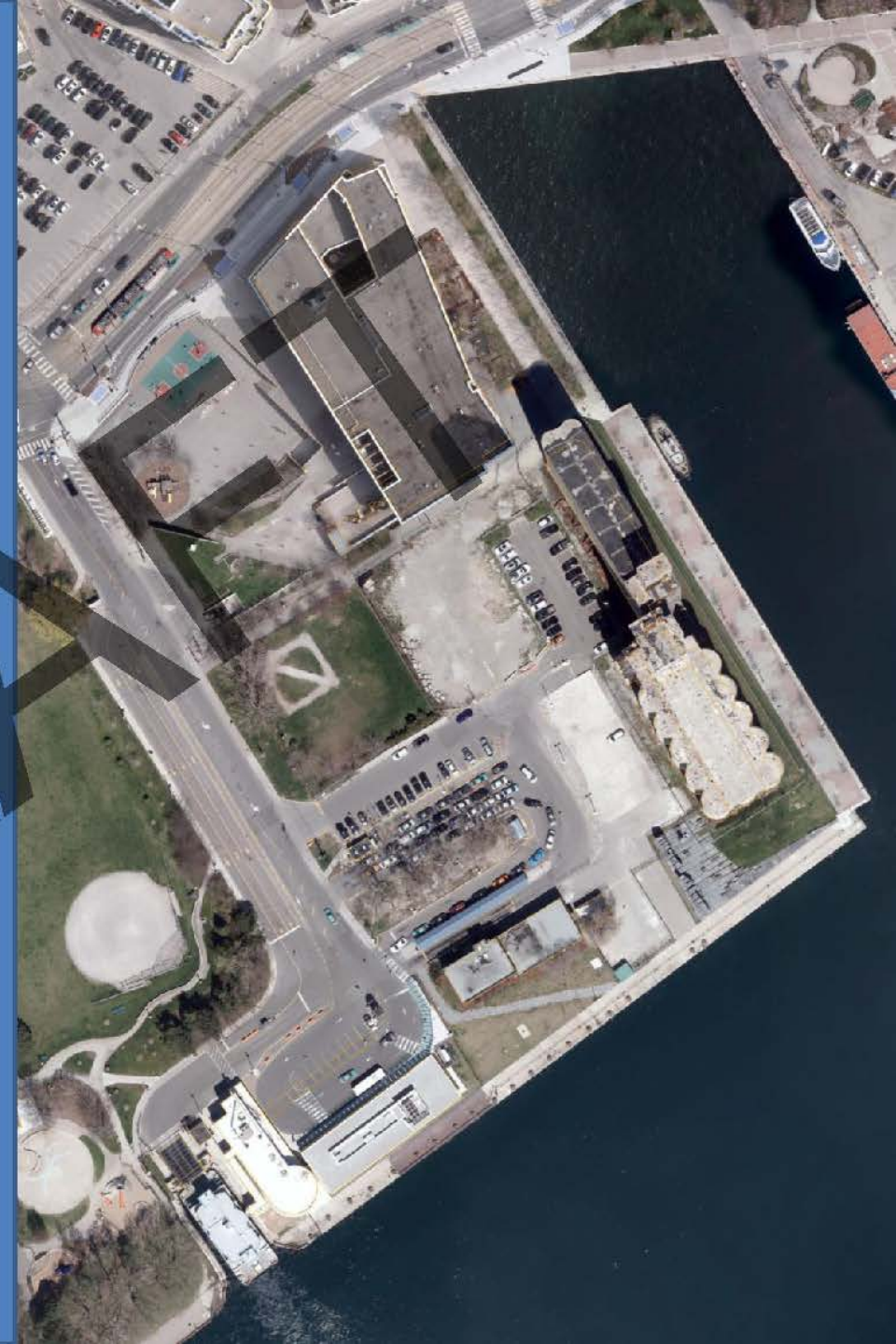

# Bathurst Quay Neighbourhood Plan (BQNP): Overview of recommendations

The silo site and Eireann Quay will play important roles in improving the Bathurst Quay neighbourhood and central waterfront.

The BQNP describes a new **LONG-TERM** vision for the silo site as a community and cultural hub on the waterfront, and potential future location of an aquatic centre.

In the **NEAR-TERM**, the BQNP recommends creating a **Streetscape and Public Realm Improvement Plan** to identify 'quick start' improvements in priority focus areas.

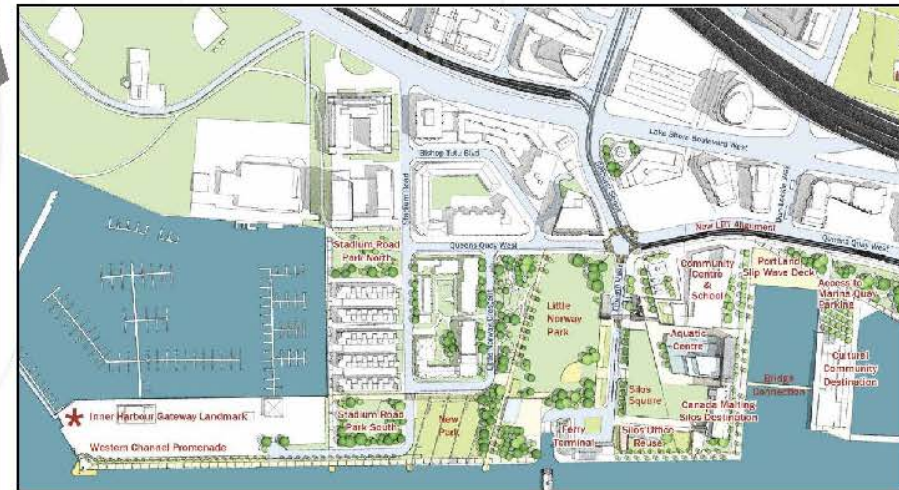
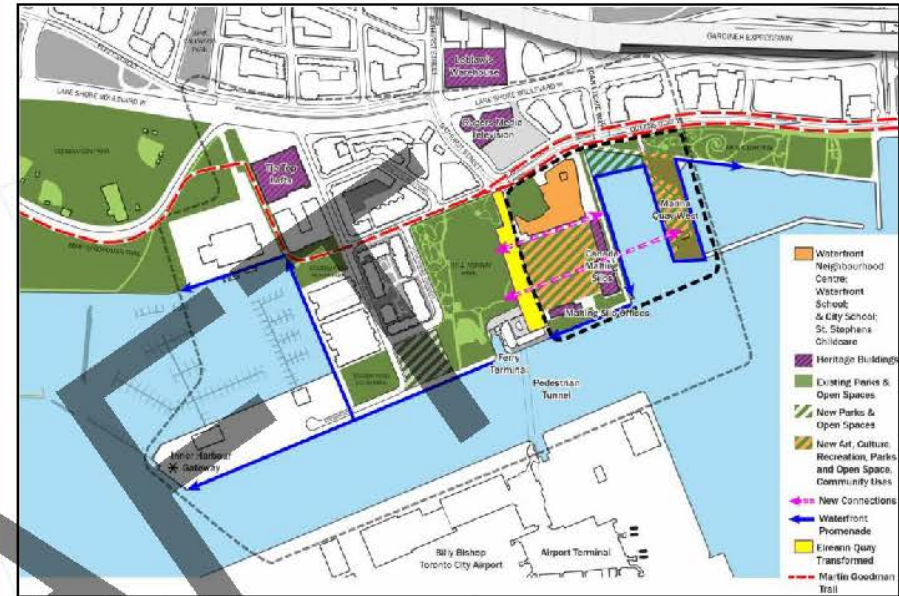

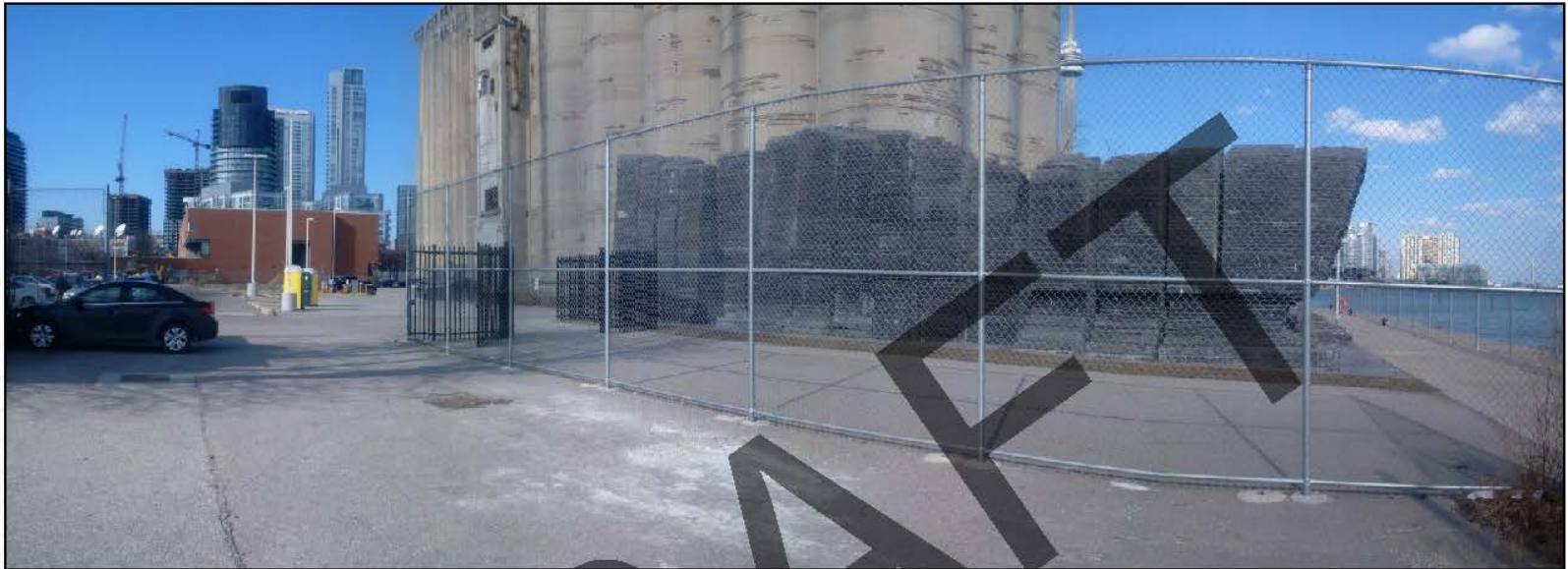

**CURRENT:** Under-utilized, derelict and/or misused public spaces.

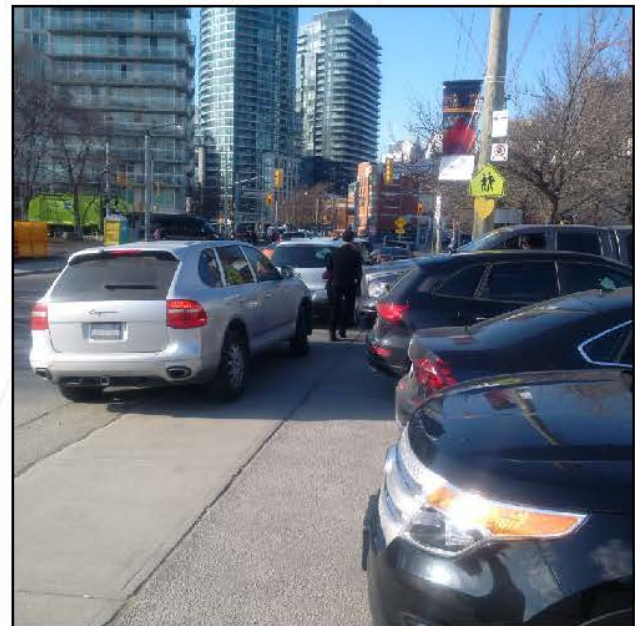
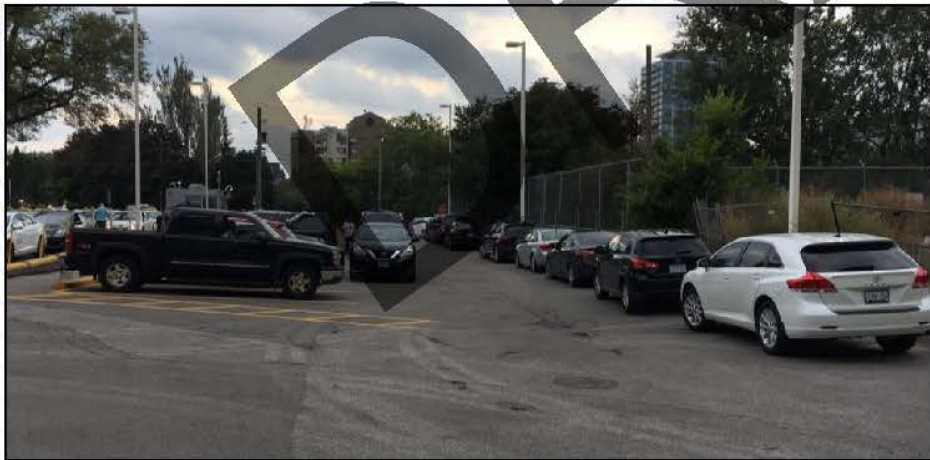

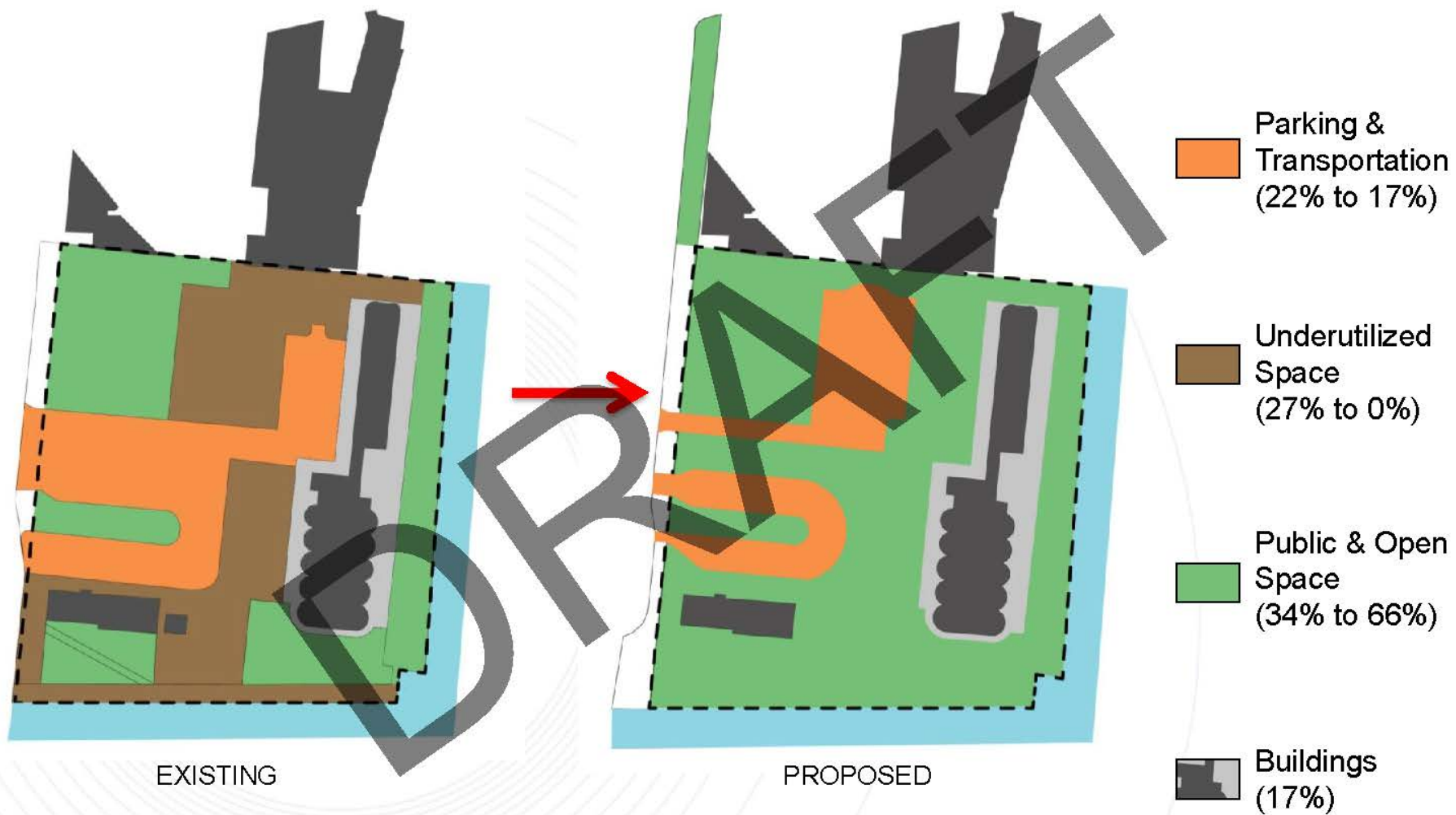



EXISTING



PROPOSED





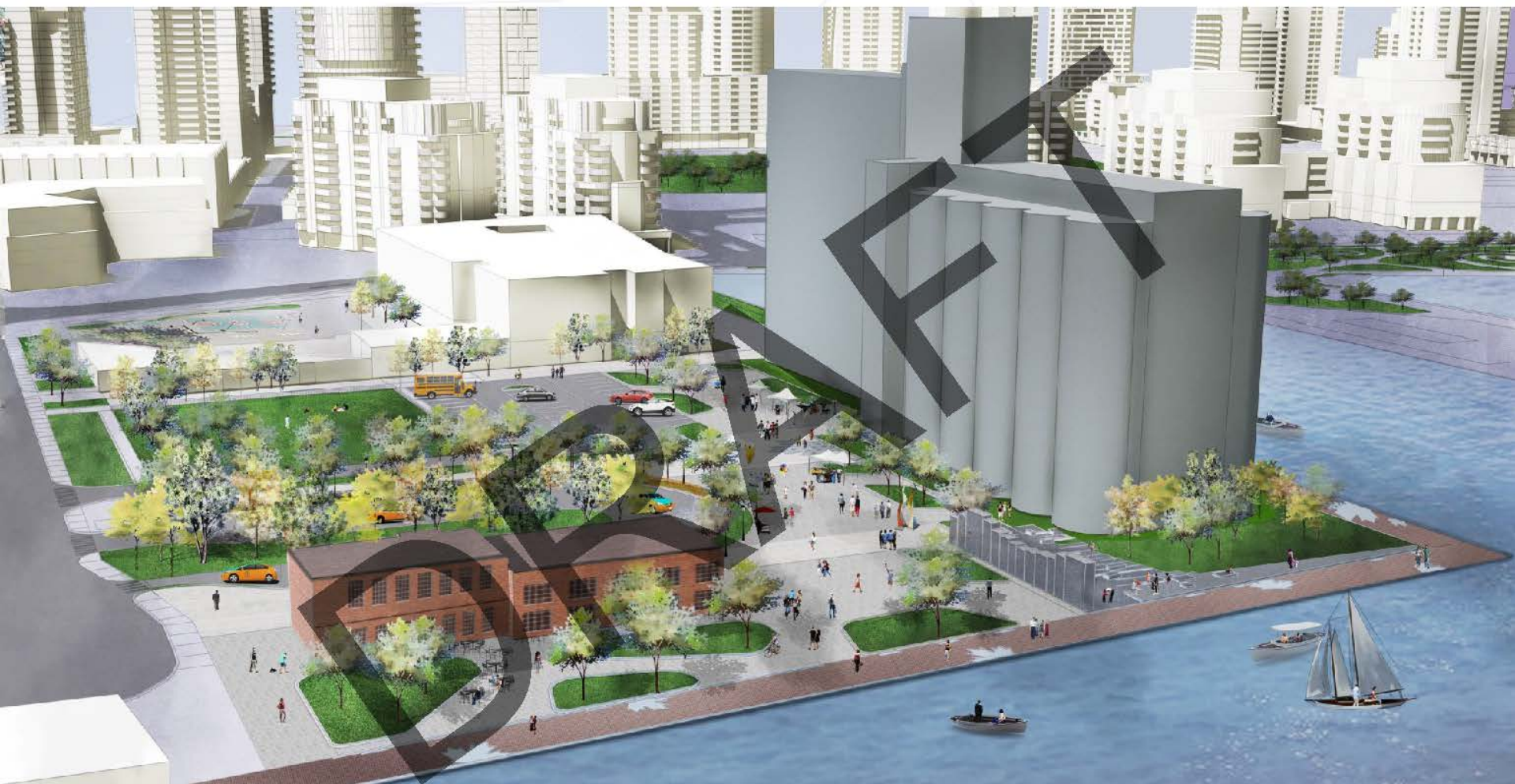

ARTIST'S RENDERING OF PROPOSED IMPROVEMENTS



## SIX KEY IMPROVEMENTS

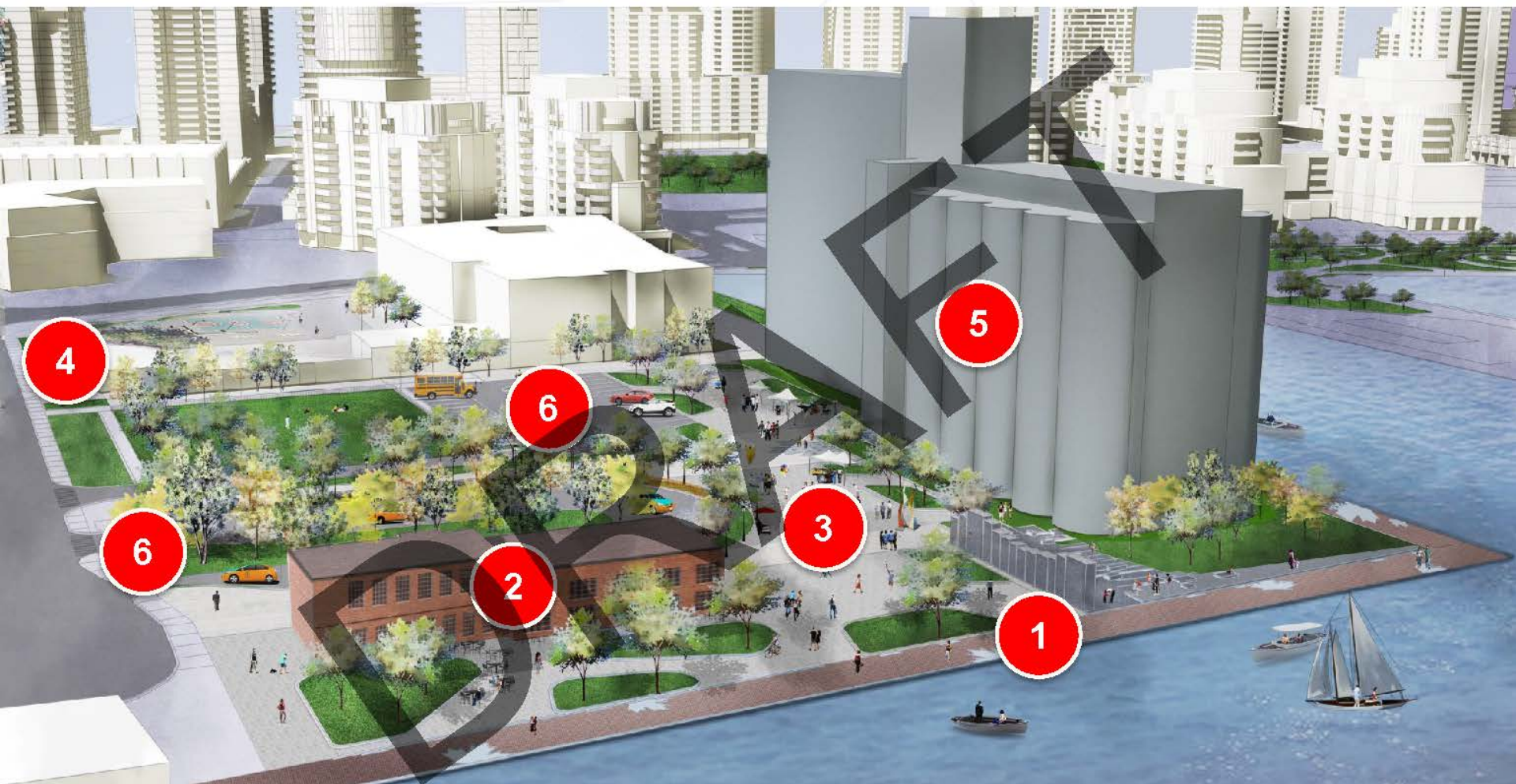

EACH PHASE DELIVERED INCREMENTALLY BY DIFFERENT PARTNERS, BUT INFORMED BY AN OVERALL MASTER PLAN.



## SIX KEY IMPROVEMENTS

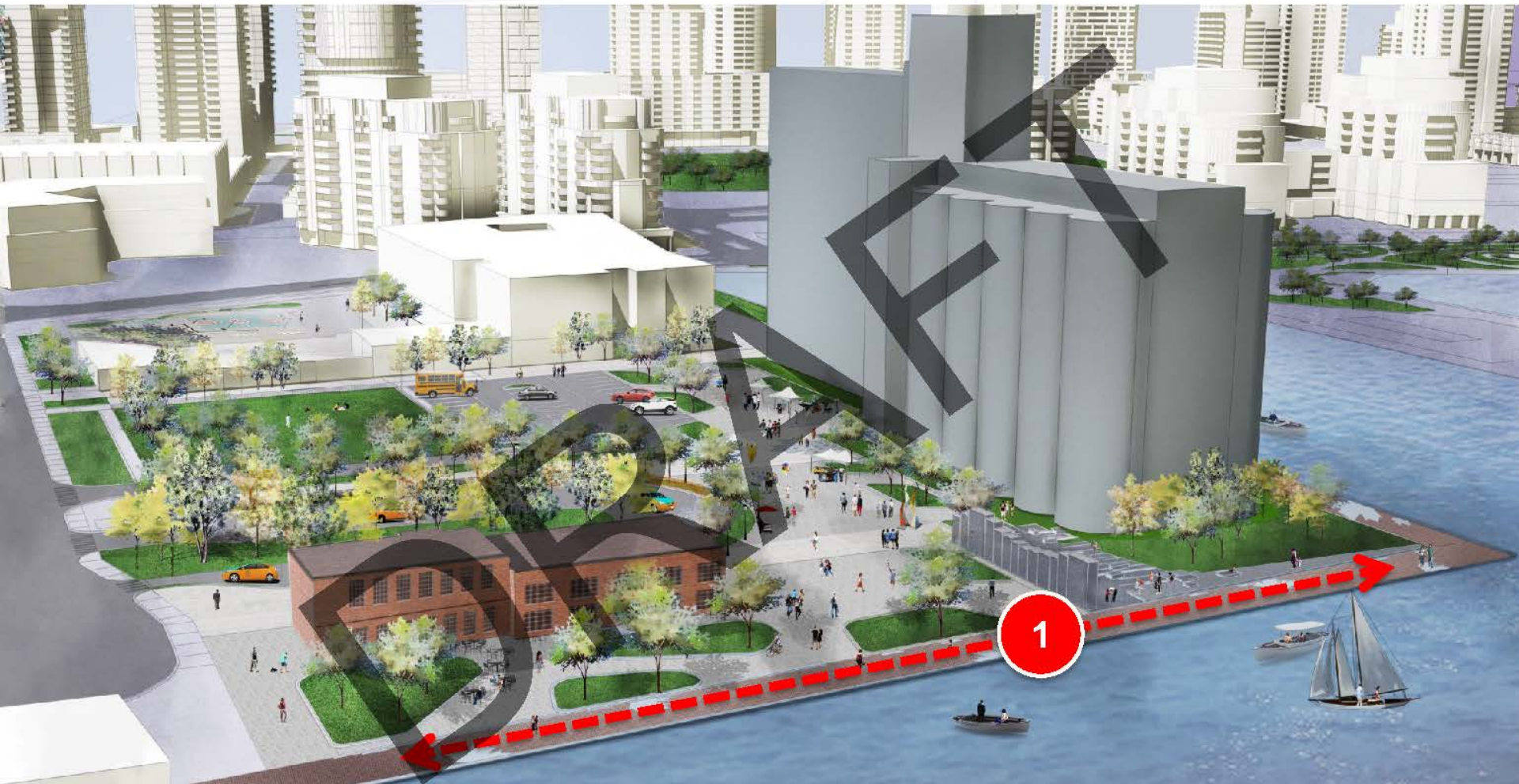

### 1: DOCKWALL REHABILITATION

**TODAY:** partially closed to the public.

**WHAT'S PLANNED?** Rehabilitation from the Portland Slip to the BBTCA ferry slip.

**WHEN?** Funding approved March 2018.  
Construction to start Spring 2019.  
To be completed Fall 2019.

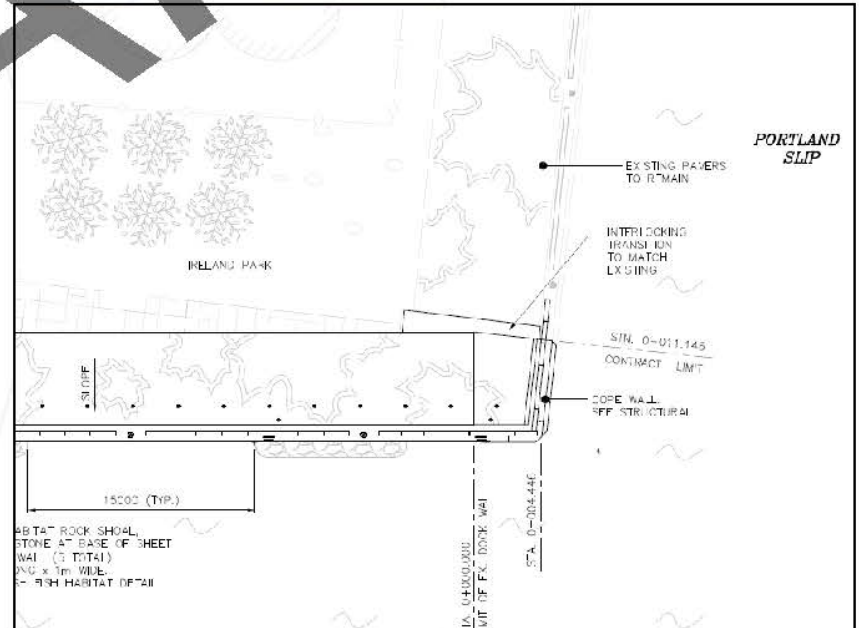
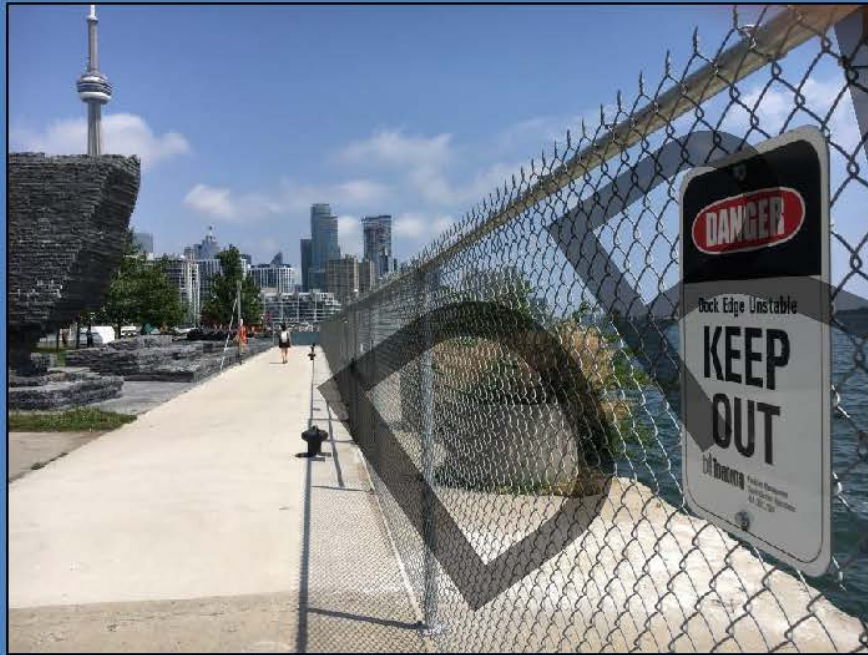



## SIX KEY IMPROVEMENTS

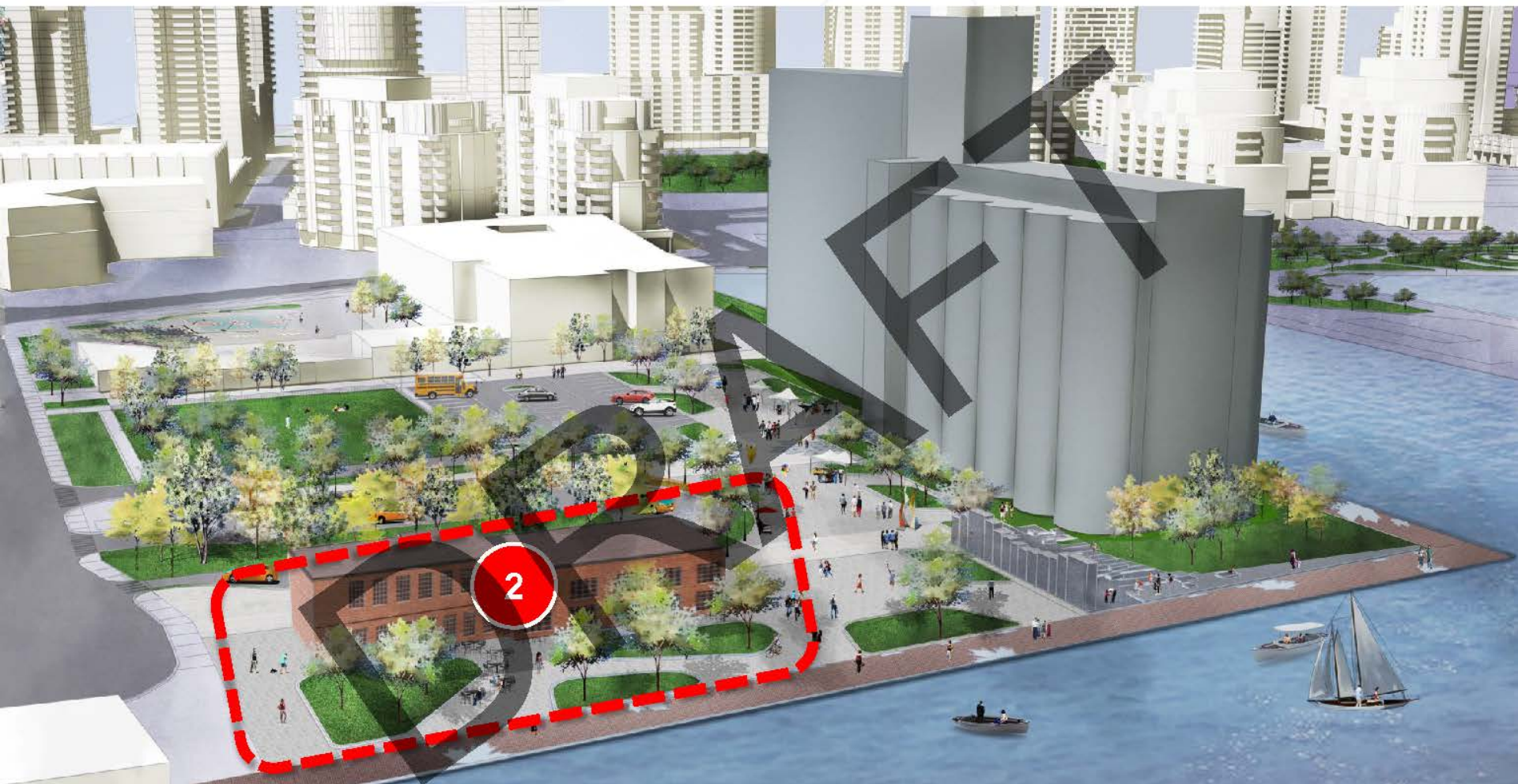

### 2: ADMINISTRATION BUILDING REVITALIZATION

**TODAY:** under-utilized three-storey office building.

**WHAT'S PLANNED?** Revitalization of building as an Arts, Heritage and Cultural Interpretative Centre operated by Ireland Park Foundation (IPF).

**WHEN?** June 2018 Council approval of nominal lease and seed capital funding. Design work underway. Construction starting 2019.



**TODAY:** under-utilized three-storey office building.

**WHAT'S PLANNED?** Revitalization of building as an Arts, Heritage and Cultural Interpretative Centre operated by Ireland Park Foundation (IPF).

**WHEN?** June 2018 Council approval of nominal lease and seed capital funding. Design work underway. Construction starting 2019.



GROUND FLOOR

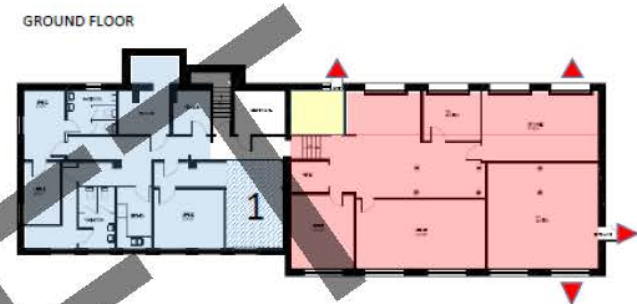

MIDDLE FLOOR



UPPER FLOOR

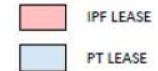



## SIX KEY IMPROVEMENTS

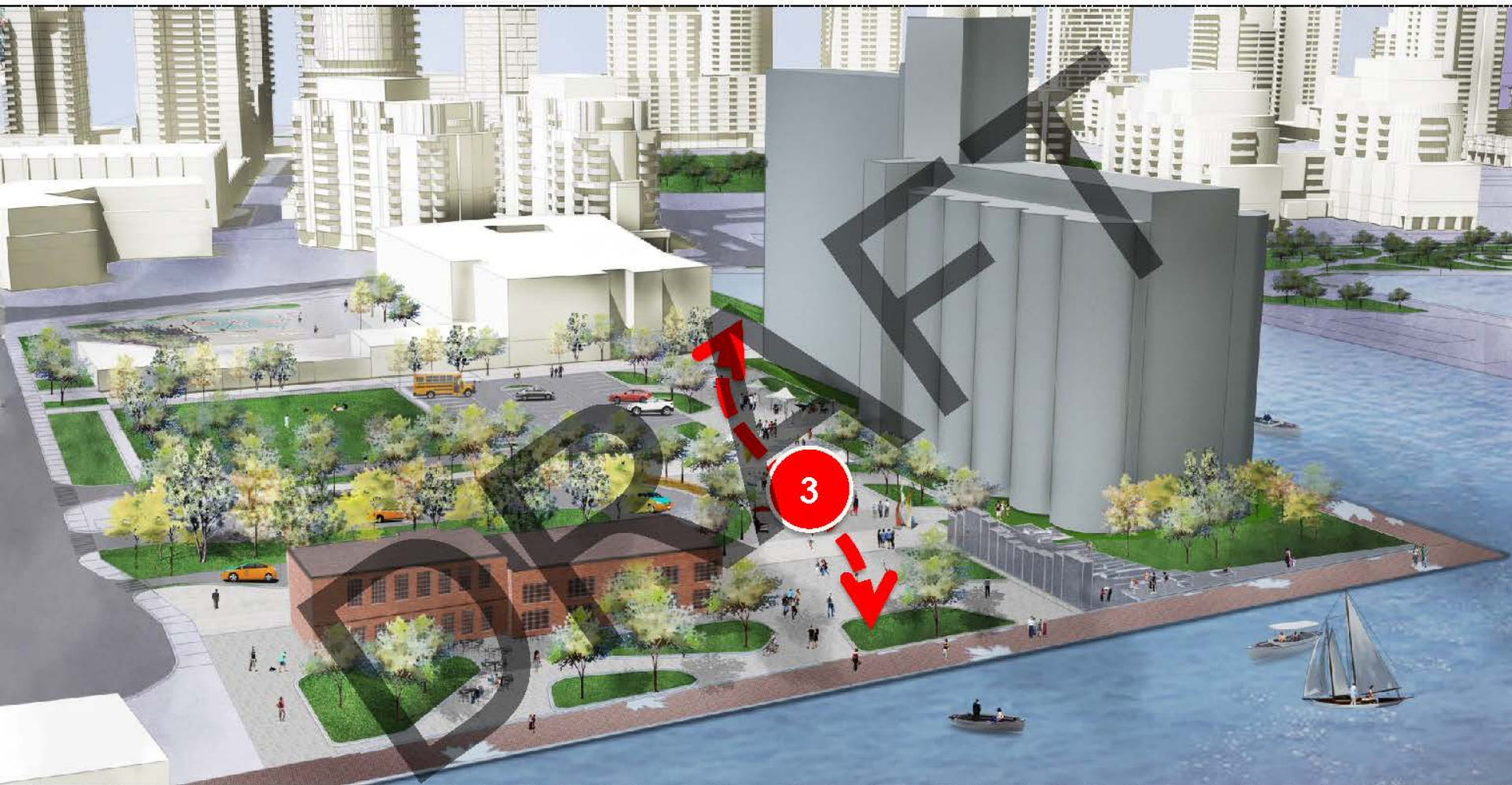

### 3: NEW PEDESTRIAN PLAZA AND PATH



**TODAY:** transportation and staging yard uses.

**WHAT'S PLANNED?** Flexible, hardscape plaza suitable for wide range of public activities.

**WHEN?** Environmental remediation and approvals process underway. Detailed design starting Summer 2019. WT DRP in 2019 and 2020. Phased construction in 2019 and 2020.



**TODAY:** transportation and staging yard uses.

**WHAT'S PLANNED?** Flexible, hardscape plaza suitable for wide range of public activities.

**WHEN?** Environmental remediation and approvals process underway. Detailed design starting Summer 2019. WT DRP in 2019 and 2020. Phased construction in 2019 and 2020.





## SIX KEY IMPROVEMENTS

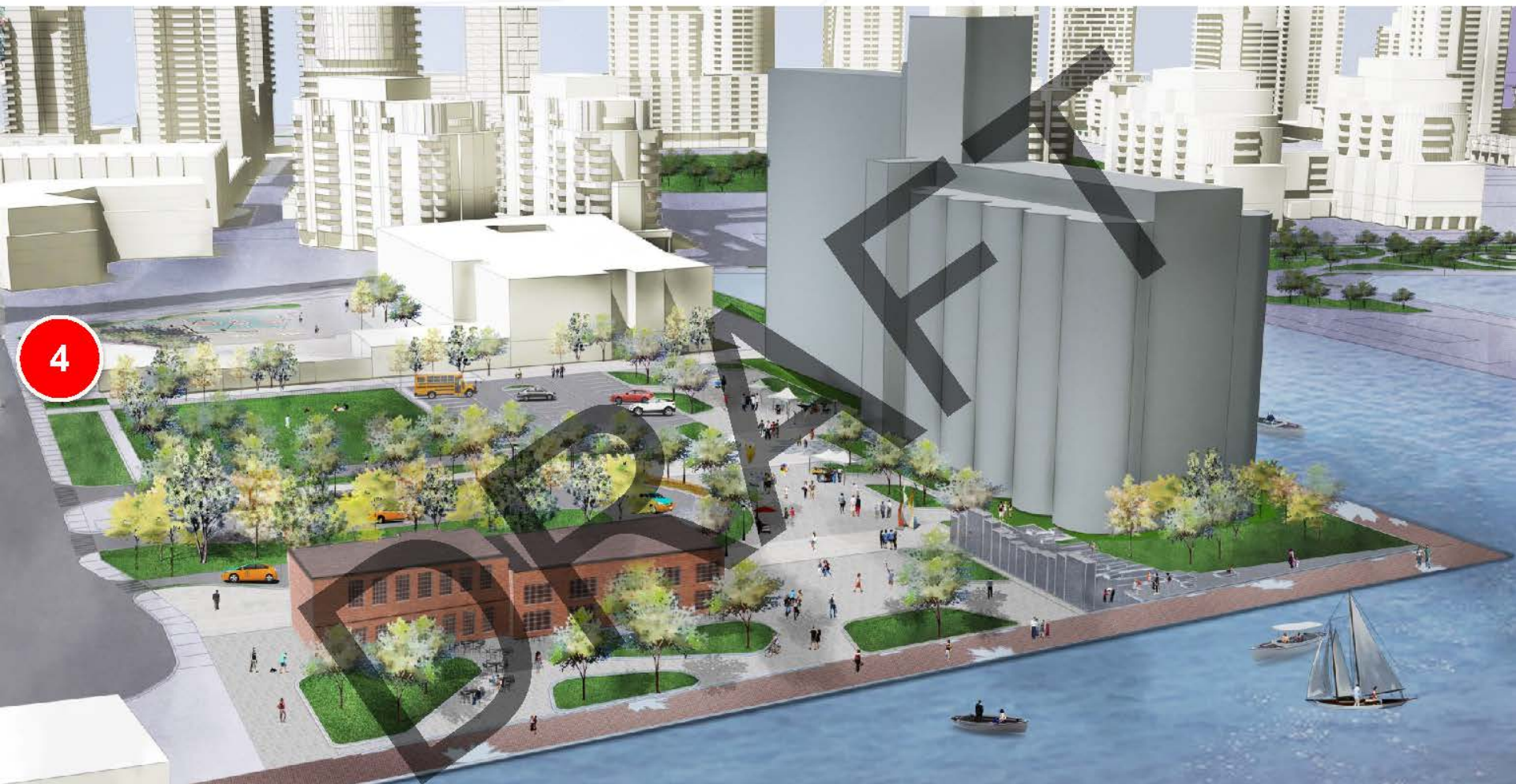

### 4: IMPROVING EIREANN QUAY

**TODAY:** School bus lay-by and sidewalk of ten blocked by illegally parked cars. Safety concerns around school playground.

**WHAT'S PLANNED?** Lay-by closed and rebuilt with sidewalk as generous pedestrian promenade. Improved edge features for playground.

**WHEN?** Detailed design starting Summer 2019. Construction in Fall 2019 or Spring 2020.

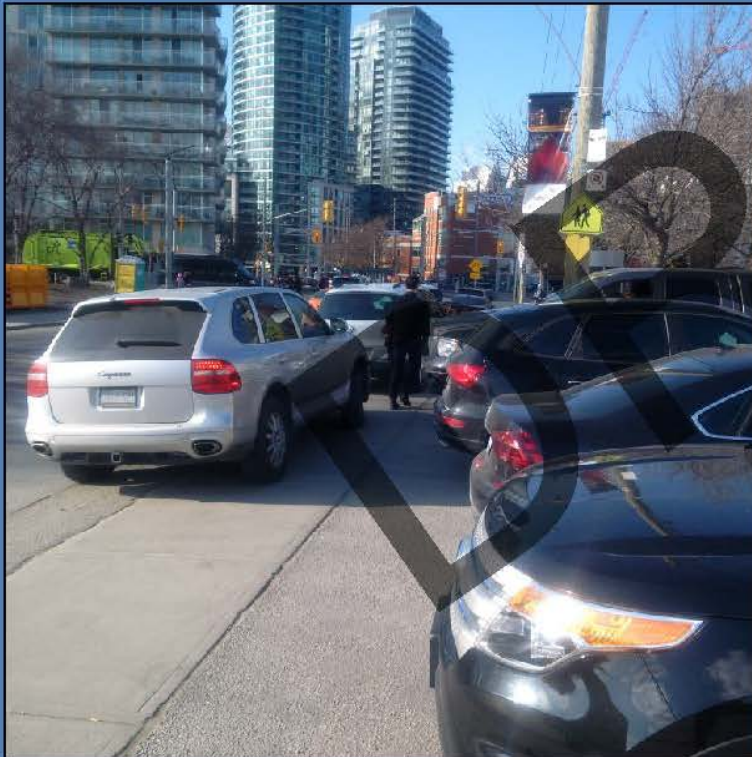



## SIX KEY IMPROVEMENTS

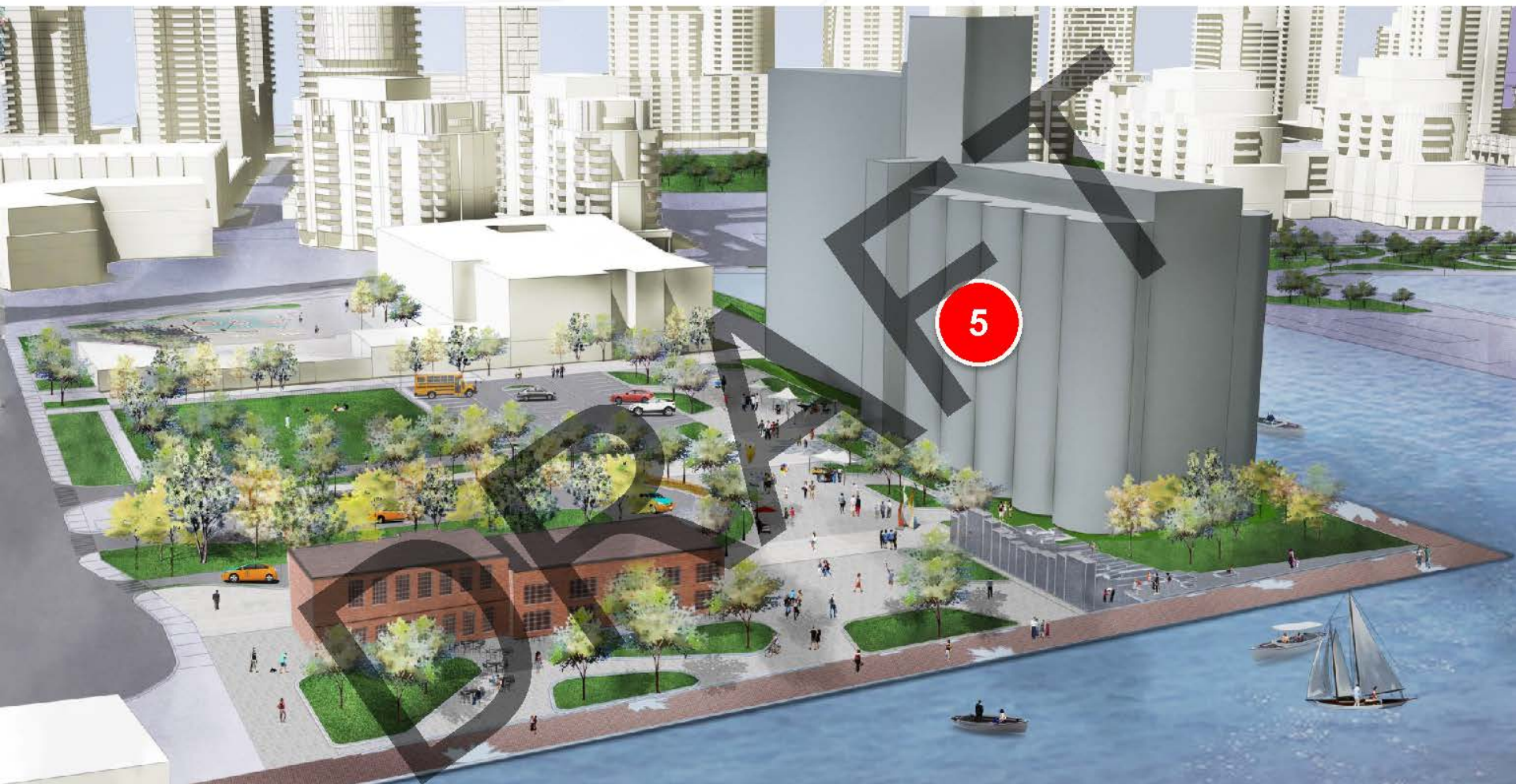

### 5: THE CANADA MALTING SILOS

**TODAY:** Designated structures under the Ontario Heritage Act. Area around silos closed due to need for building repairs.

### WHAT'S PLANNED?

In the near-term, detailed design team will explore low-cost measures to improve the appearance of the silos.

An inter-agency team will develop a long-term Implementation and Funding Strategy for revitalization of the silos (in tandem with exploring aquatic centre, expanded community centre, and below-grade parking and transportation uses).

**WHEN?** To be informed by findings of Building Condition Assessment by Facilities Management.

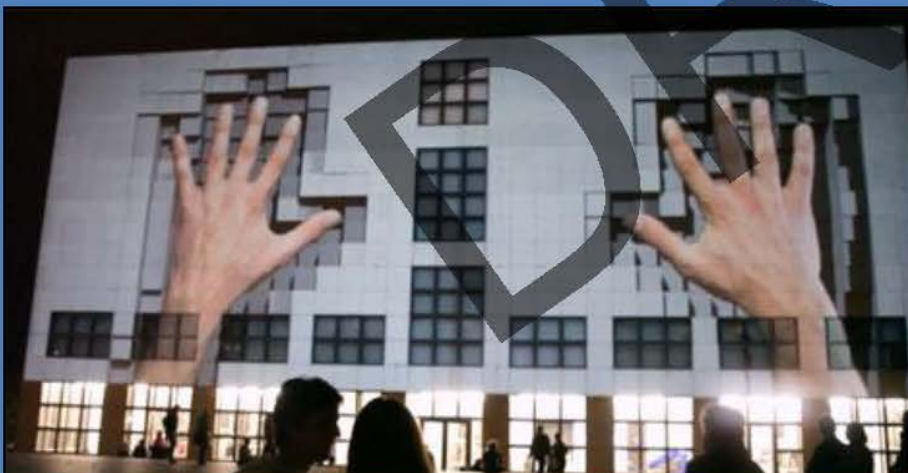
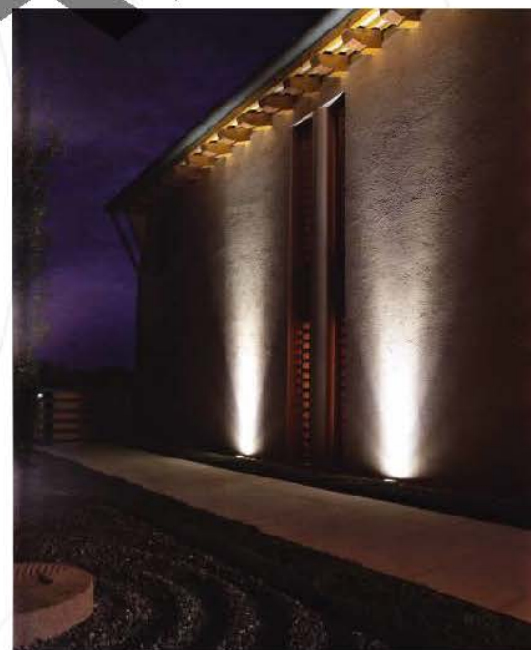



## SIX KEY IMPROVEMENTS

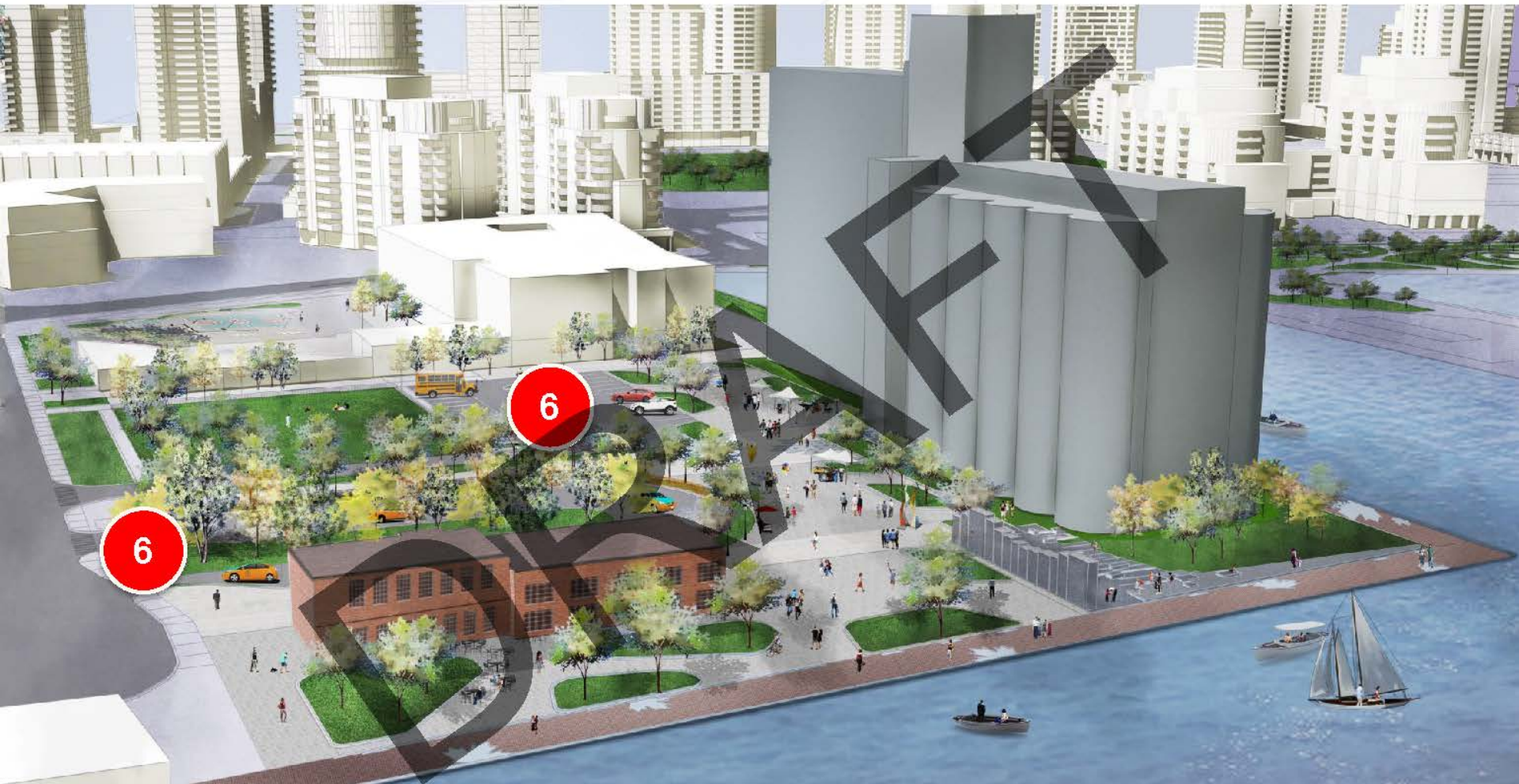

3: PARKING & TRANSPORTATION WORKS  
(CURRENT SITE PLAN CONTROL APPLICATION)

**TODAY:** Ports Toronto-leased parking areas and taxi corral. TDSB and community parking spaces. Three-lane finger lot adjacent to Little Norway Park. Bus lay-by on Eireann Quay.

**WHAT'S PLANNED?** Consolidation of passenger pick-up parking to narrowed finger lot. Reduced taxi corral footprint. Shared surface parking lot with TDSB and school bus. Regrading of site to support future improvements by City.

**WHEN?** Finger lot reconfiguration work completed December 2018. Taxi corral and parking area subject to site plan approval. Construction expected Summer 2019.





**TODAY:** Ports Toronto-leased parking areas and taxi corral. TDSB and community parking spaces. Three-lane finger lot adjacent to Little Norway Park. Bus lay-by on Eireann Quay.

**WHAT'S PLANNED?** Consolidation of passenger pick-up parking to narrowed finger lot. Reduced taxi corral footprint. Shared surface parking lot with TDSB and school bus. Regrading of site to support future improvements by City.

**WHEN?** Finger lot reconfiguration work completed December 2018. Taxi corral and parking area subject to site plan approval. Construction expected Summer 2019.

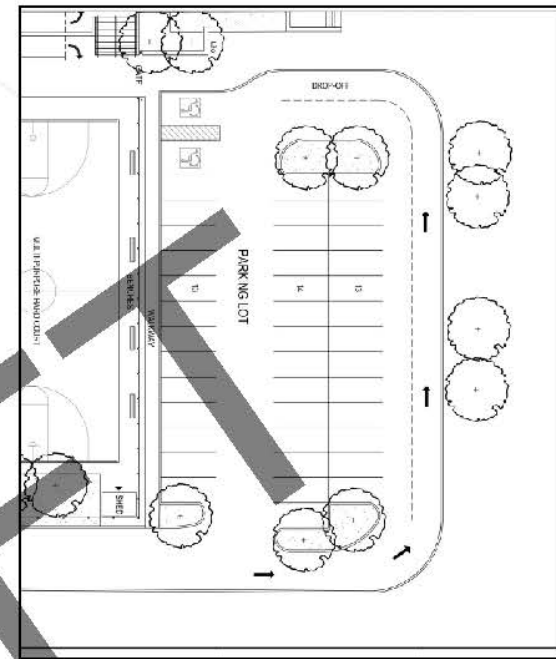

# Construction schedule overview

- 1: Consolidation of traffic operations in ferry queue. Completed December 2018.
- 2: Western Channel Dockwall Rehabilitation. Spring 2019 – Fall 2019.
- 3: Reduced taxi corral and shared parking lot. Summer 2019.
- 4: Ireland Park Foundation. Renovations beginning Summer 2019.
- 5: Eireann Quay streetscape improvements. Summer 2019 – Spring 2020.
- 6: New plaza and open space. Phased construction in 2019 and 2020. Opening expected in Fall 2020 (contingent on timing of environmental approvals).

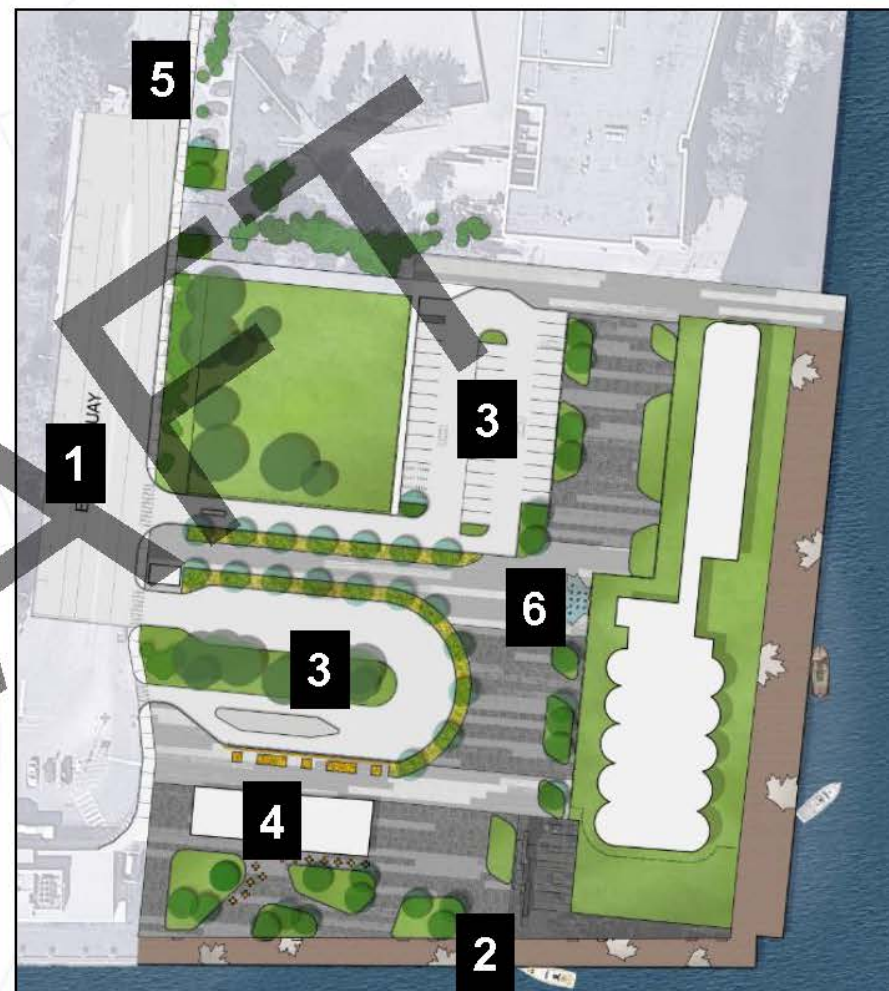

# Stakeholder consultation

Design process for public plaza will incorporate meaningful opportunity for stakeholder input. These shall include:

- Design presentations by detailed design team (details TBC in 2019 RFP document).
- Programming consultation with WaterfrontToronto, BIA and other partners.
- Conceptual and detailed plaza design to be presented to WaterfrontToronto Design Review Panel.
- Regular project updates to BQNA (and other community organizations on request).
- TDSB managing parallel consultation on playground and open space master plan.



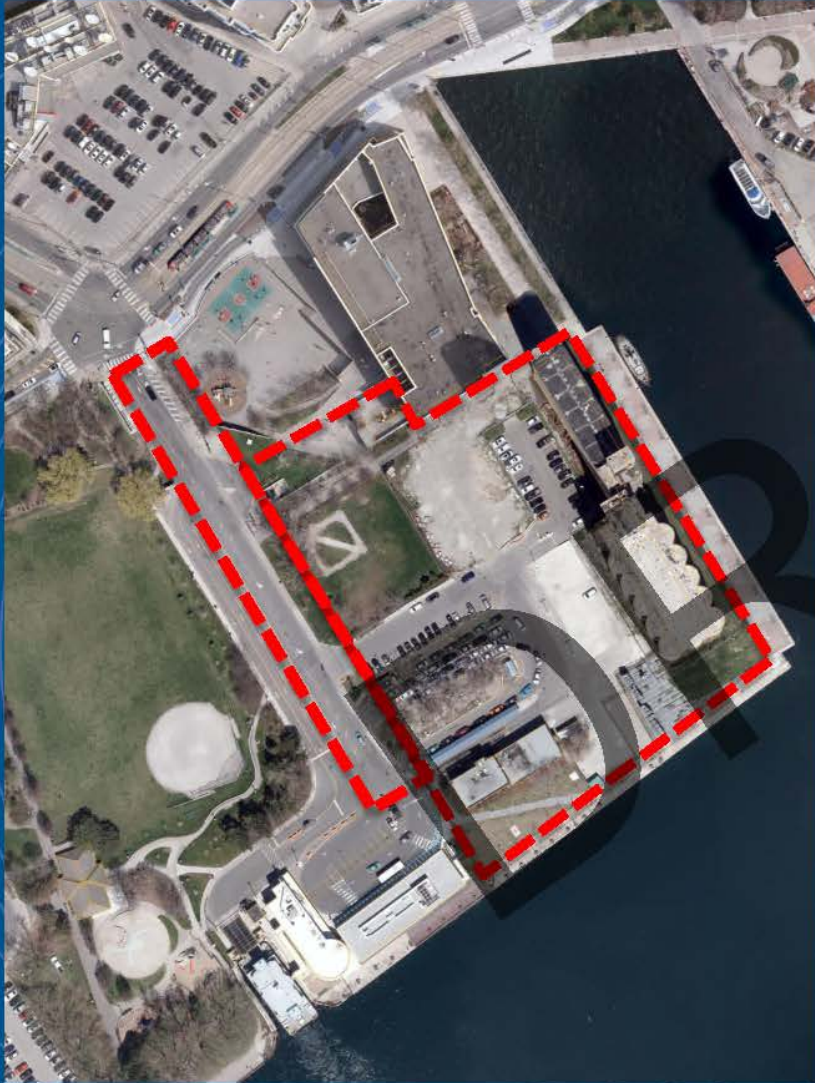

# QUESTIONS? COMMENTS?

Bryan Bowen  
Project Manager, Waterfront Secretariat  
City Planning Division  
416-338-4842  
[bryan.bowen@toronto.ca](mailto:bryan.bowen@toronto.ca)

# PORTS TORONTO - BILLY BISHOP AIRPORT

## CITY SIDE MODERNIZATION PROJECT: MALTING SITE IMPROVEMENTS

Contract No.: XXXX-XXX-XX

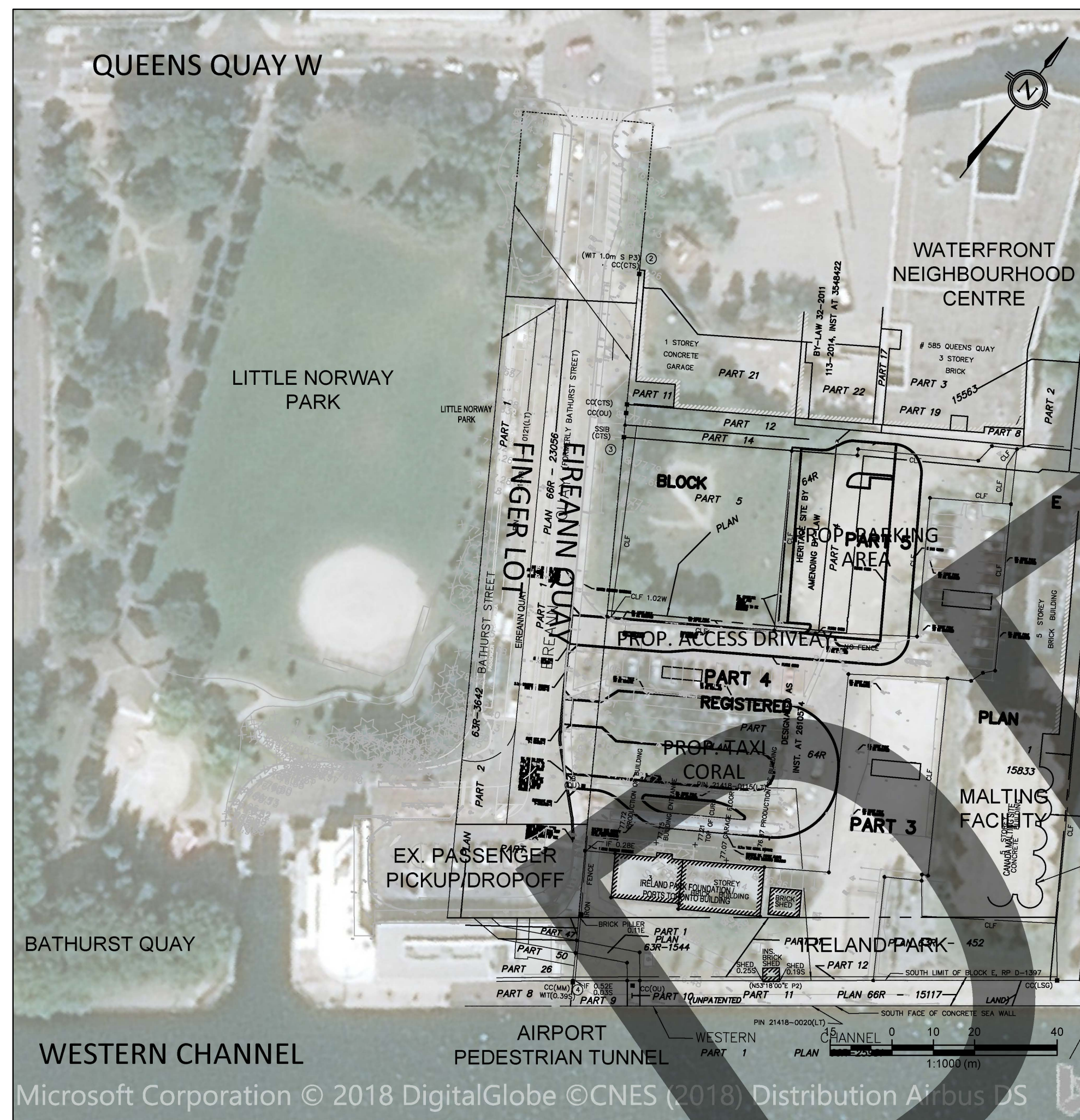

**AERIAL MAP**  
SCALE = 1:1000

DRAWING INDEX		
SHEET NUMBER	DRAWING NUMBER	DRAWING NAME
		COVER SHEET & DRAWING INDEX
		LANDSCAPE ARCHITECT'S RENDERINGS
1 OF 20	01	SITE / CONTEXT PLAN
2 OF 20	02	SITE SECTIONS/ CANOPY ELEVATIONS
3 OF 20	GN-1	GENERAL NOTES
4 OF 20	BND-1	BOUNDARY PLAN
5 OF 20	NCP-1	NEW CONSTRUCTION PLAN
6 OF 20	GRD-1	GRADING PLAN
7 OF 20	CIV-1	SERVICING PLAN
8 OF 20	ESC-1	EROSION & SEDIMENT CONTROL PLAN
9 OF 20	LAND-1	LANDSCAPE & LIGHTING PLAN
10 OF 20	TPP-1	TREE PROTECTION PLAN
11 OF 20	SEC-1	ALIGNMENT LOCATION PLAN
12 OF 20	PRO-1	PROFILE 1 & 2
13 OF 20	PRO-2	PROFILE 3
14 OF 20	PRO-3	PROFILE 4
15 OF 20	PRO-4	PROFILE 5
16 OF 20	PRO-5	PROFILE 6
17 OF 20	PRO-6	PROFILE 7
18 OF 20	PRO-7	PROFILE 8
19 OF 20	PRO-8	PROFILE 9
20 OF 20	PRO-9	PROFILE 10

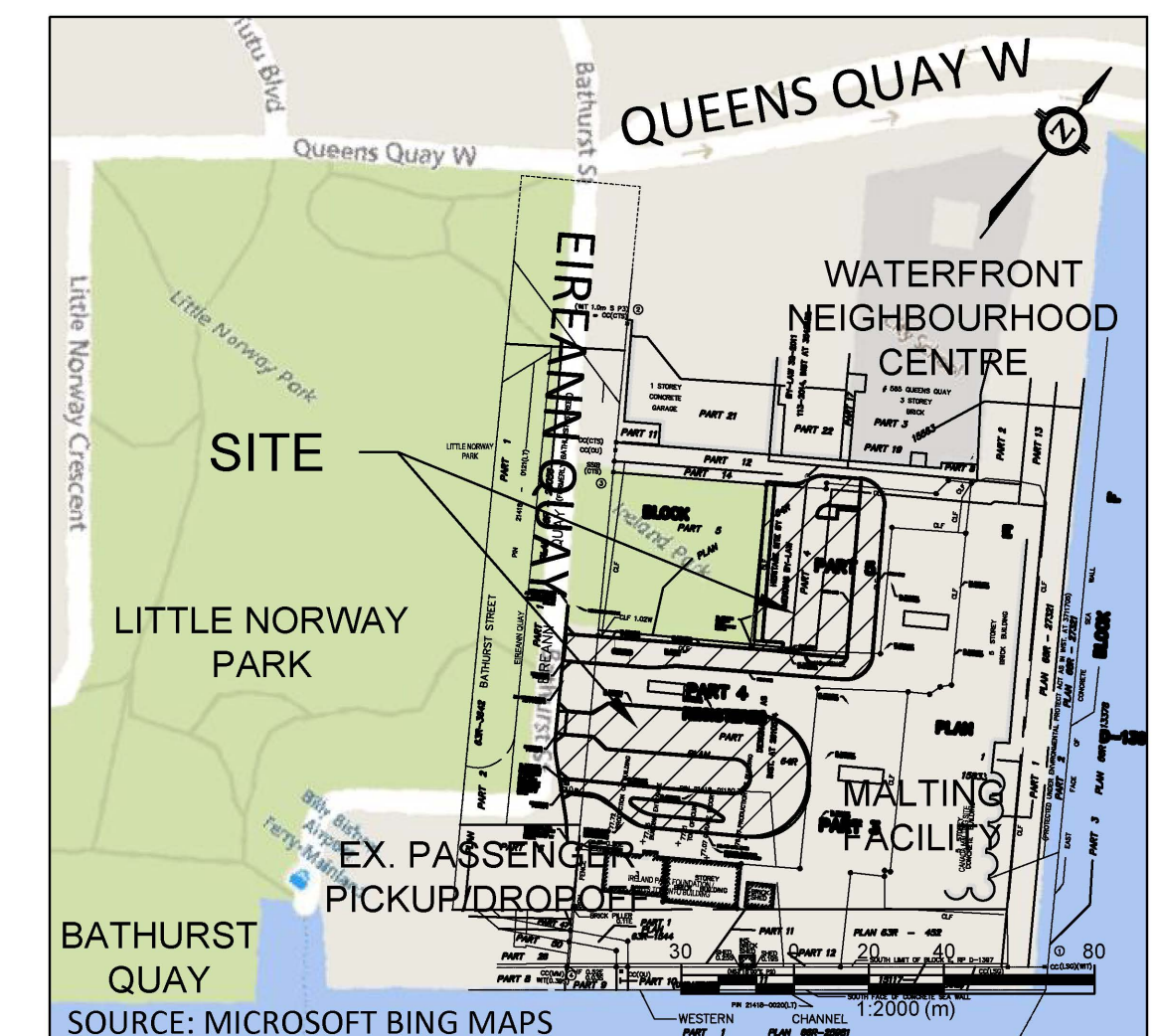

**LOCATION PLAN**  
SCALE = 1:2000

**ISSUED FOR SPA SUBMISSION**  
March 4, 2019

FOR SUBMISSION

**PORTS  
TORONTO**

**DILLON  
CONSULTING**

Dillon Project No.: 18-7640

No.	DATE	REVISIONS
1	03/04/19	ISSUED FOR SPA SUBMISSION



**SITE PLAN LEGEND**

	EXISTING BUILDING
	NEW ADDITION
	EXISTING FENCE TO BE REMOVED
	EXISTING JERSEY BARRIERS TO BE REMOVED
	PROPOSED TREE
	RELOCATED TREE
	EXISTING TREE
	EXISTING FIREHYDRANT
	EXISTING LIGHT STANDARD
	MANHOLE
	ENTRANCE / EXIT
	EXIT

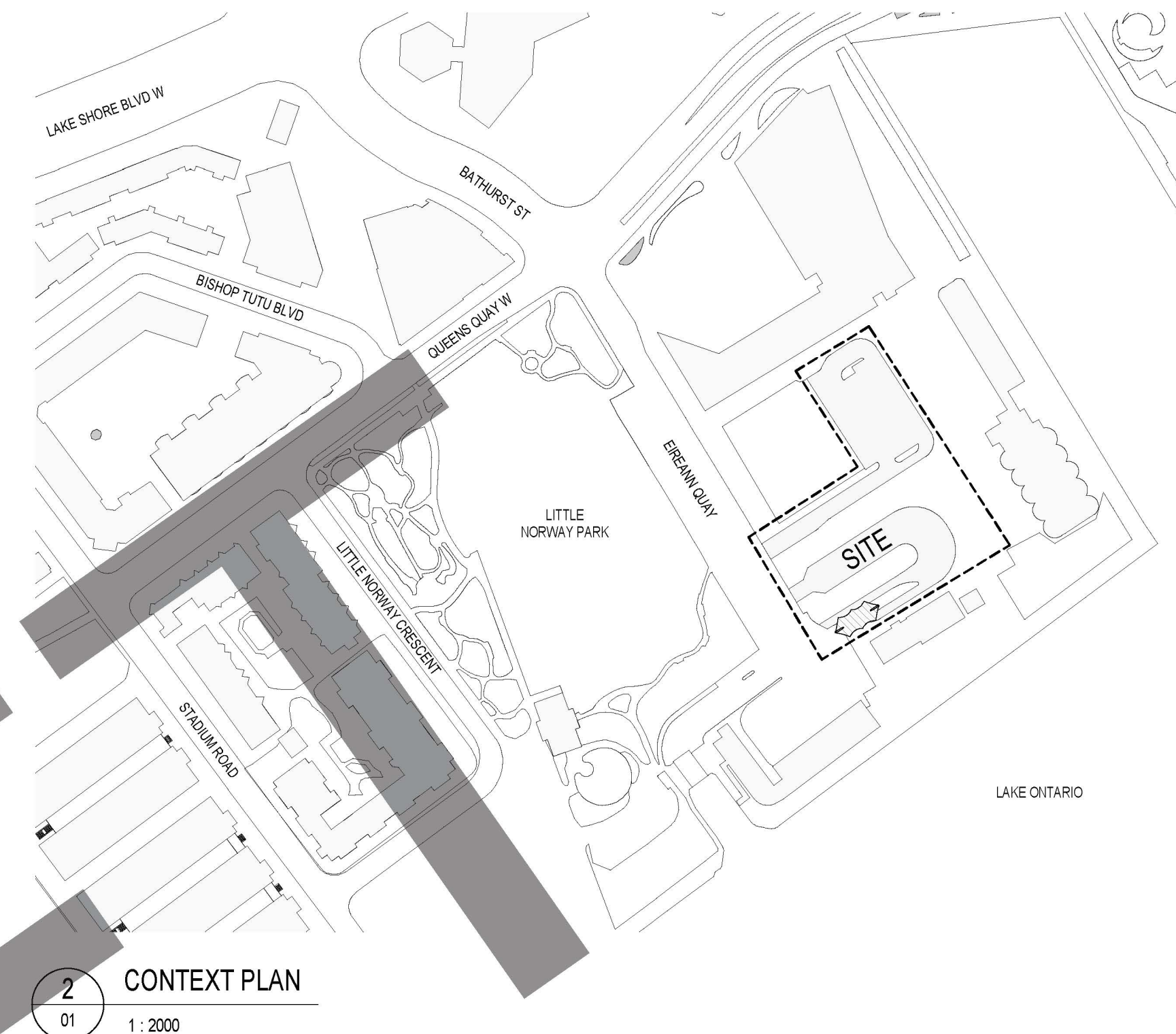

2  
01  
CONTEXT PLAN  
1: 2000

NOTE: FOR ALL SITE INFORMATION, REFER TO DRAWINGS BY DILLON CONSULTING

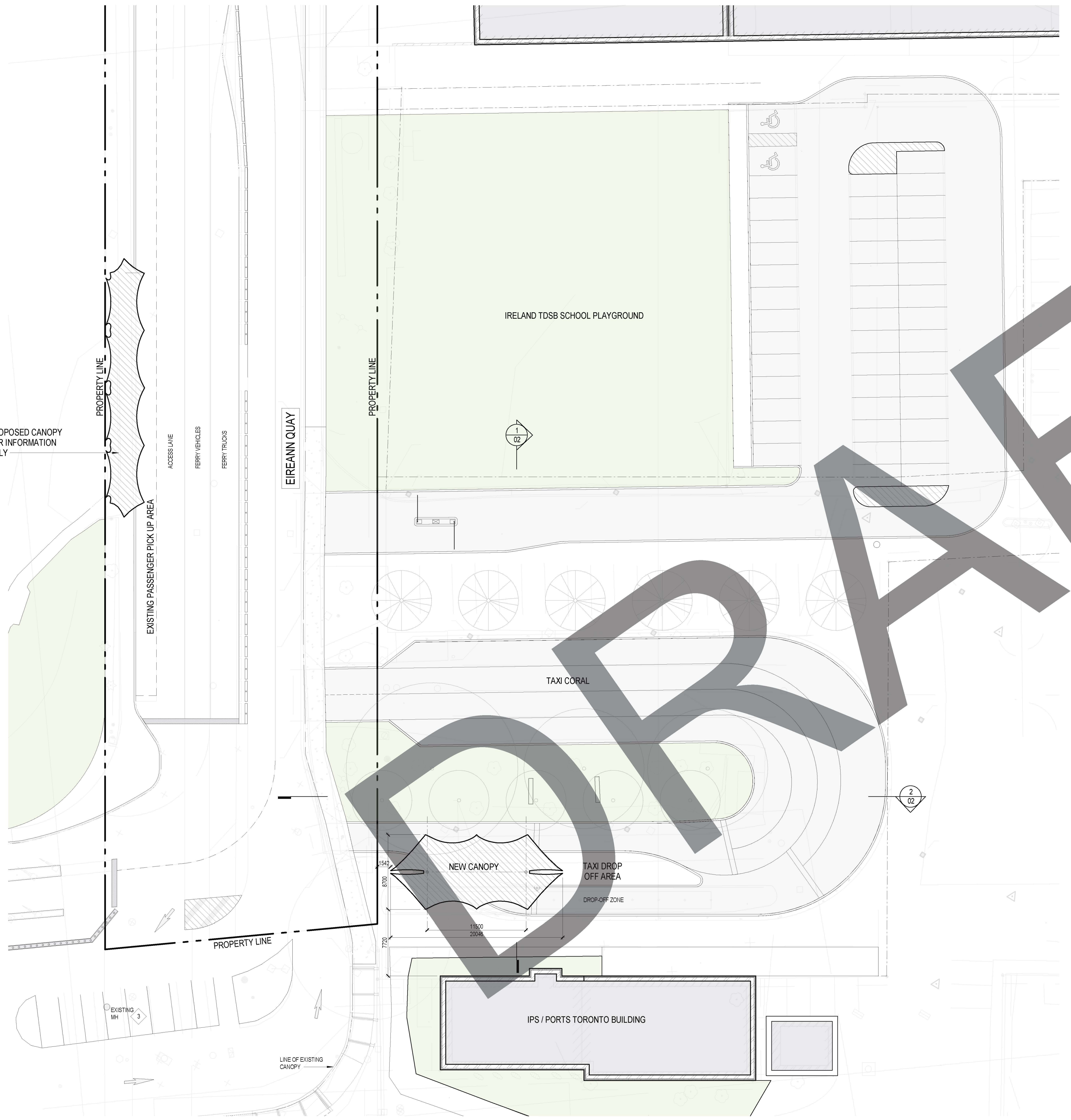

1  
01  
SITE PLAN  
1: 250

13/02/2019 ISSUED FOR SPA APPROVAL  
 # date: revision: by:  
 revisions



All drawing and specifications are the property of the architect. The contractor shall verify all dimensions and information on site and report any discrepancy to architect before.

**BILLY BISHOP AIRPORT**  
 CITY SIDE MODERNIZATION  
 PROJECT:  
 MALTING SITE IMPROVEMENTS

**SITE/ CONTEXT PLAN**

scale: As indicated  
 drawn by: HM  
 reviewed by: RSD  
 job number: 0001  
 plot date: 04/03/2019

drawing number  
**01** 1 of 20

2019-03-01 4:31:14 PM H:\18020\_Billy Bishop\07\_DWGOS & SCHEDULES\01\_Drawing\MSA\_Billy Bishop\_20190129.rvt

**SITE SECTION LEGEND**

	EXISTING BUILDING
	NEW ADDITION

**ELEVATION LEGEND**

	EXISTING BUILDING
	NEW ADDITION
	PVC TENSILE FABRIC
	METAL CABLES
	PAINTED METAL
	CONCRETE
	HARDWOOD

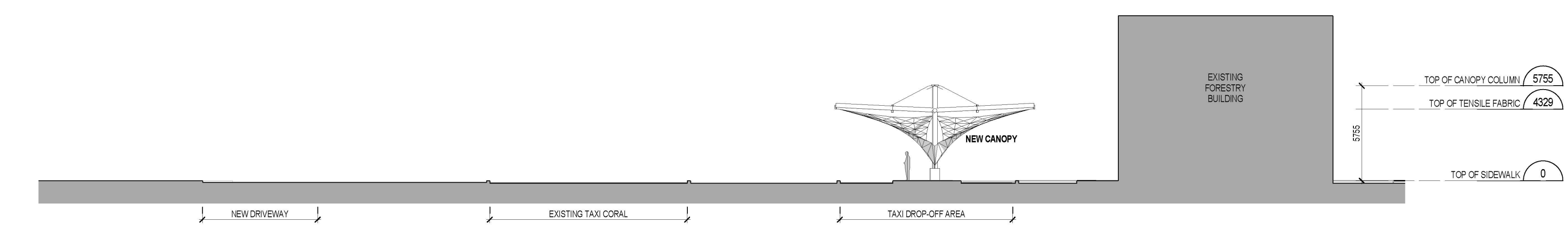

1 SITE SECTION - NORTH/SOUTH  
 02 1 : 200

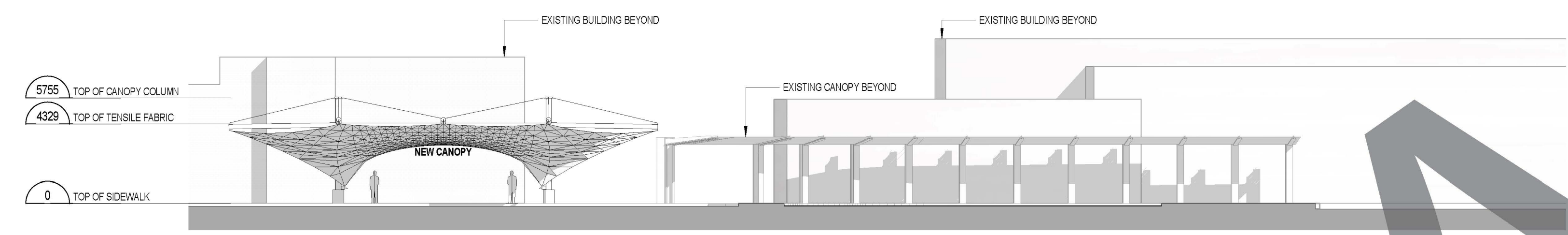

2 SITE SECTION - EAST/WEST  
 02 1 : 200

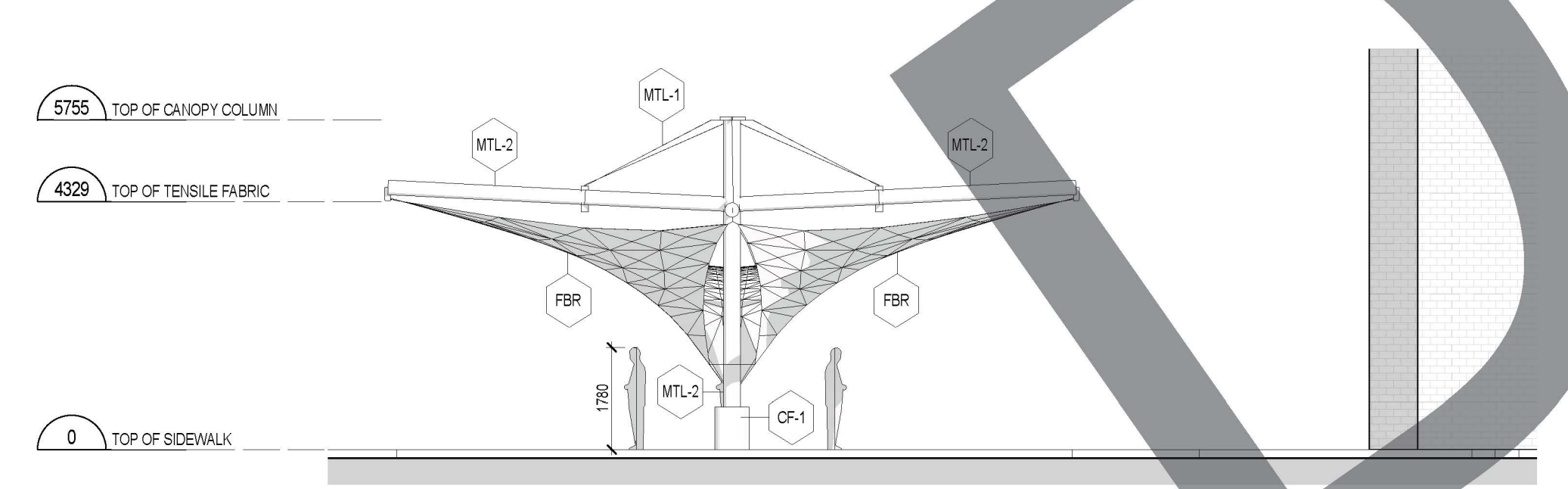

3 EAST ELEVATION  
 02 1 : 100

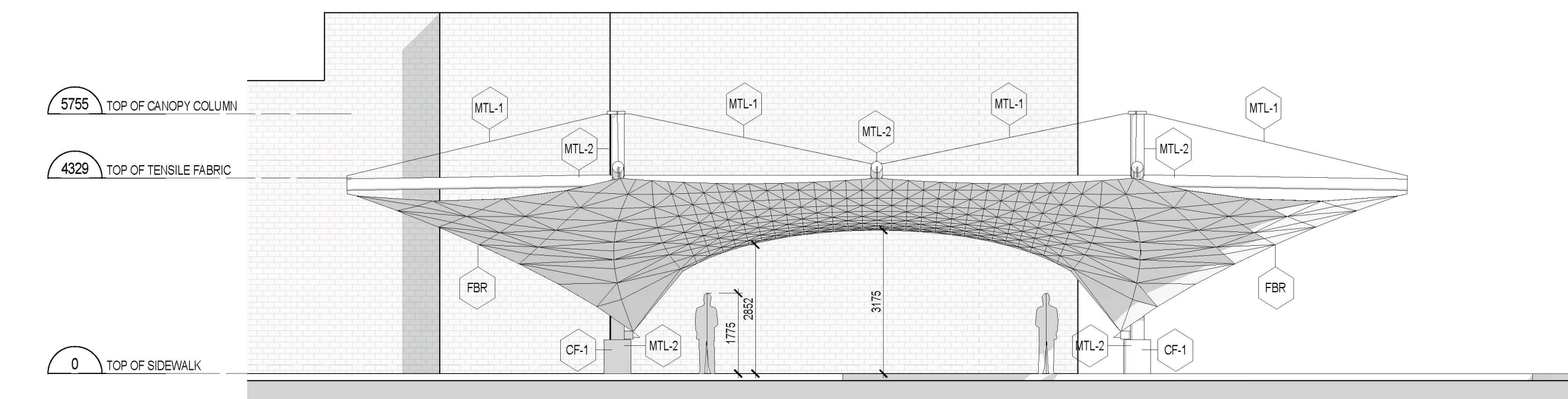

4 NORTH ELEVATION  
 02 1 : 100

DRAFT

13/02/2019	ISSUED FOR SPA APPROVAL
# date:	revision: by:
revisions	

ONTARIO ASSOCIATION OF ARCHITECTS  
**R S DAVIS**  
 ROBERT DAVIES  
 LICENCE 4333

All drawing and specifications are the property of the architect. The contractor shall verify all dimensions and information on site and report any discrepancy to architect before.

**BILLY BISHOP AIRPORT**  
 CITY SIDE MODERNIZATION  
 PROJECT:  
 MALTING SITE IMPROVEMENTS

**SITE SECTIONS/ CANOPY ELEVATIONS**

scale:	As indicated
drawn by:	HM
reviewed by:	TR
job number:	0001
plot date:	04/03/2019

drawing	02	drawing number	2 of 20
---------	----	----------------	---------



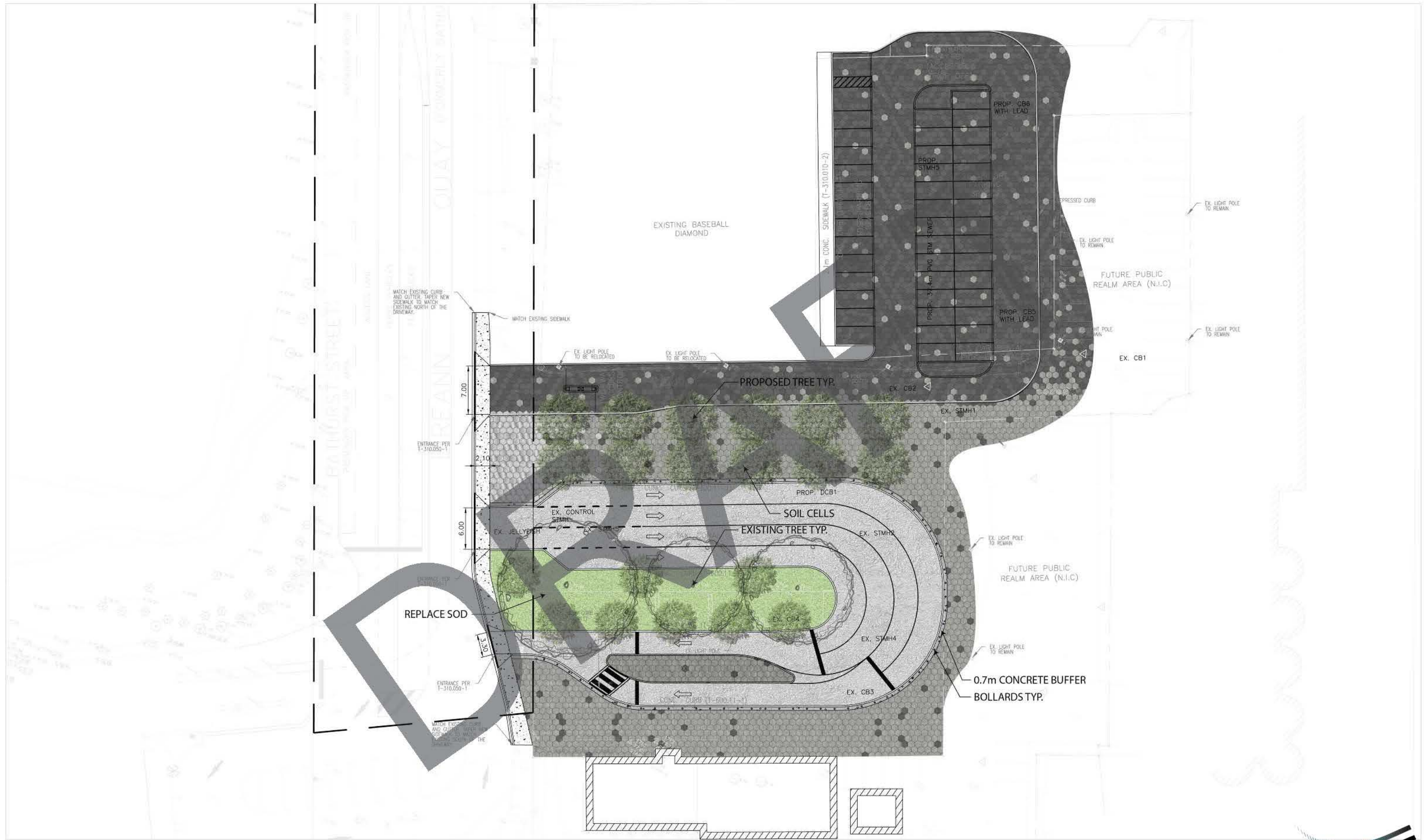



Non-Permeable, City Park Pavers - UNILOCK



Permeable, City Park Pavers - UNILOCK



MAGLIN - MTB500 Series



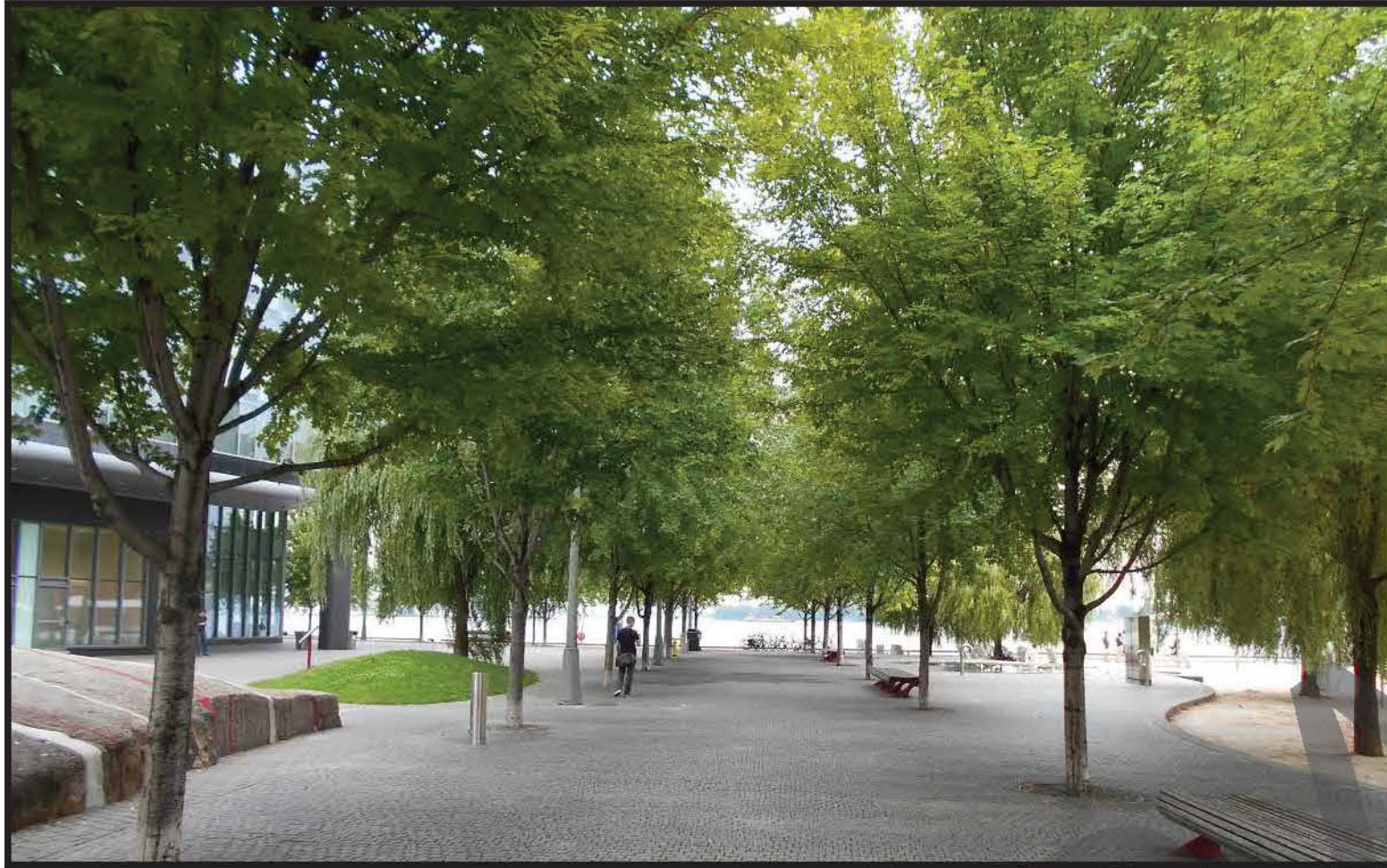

Deeproot - Silva Cells

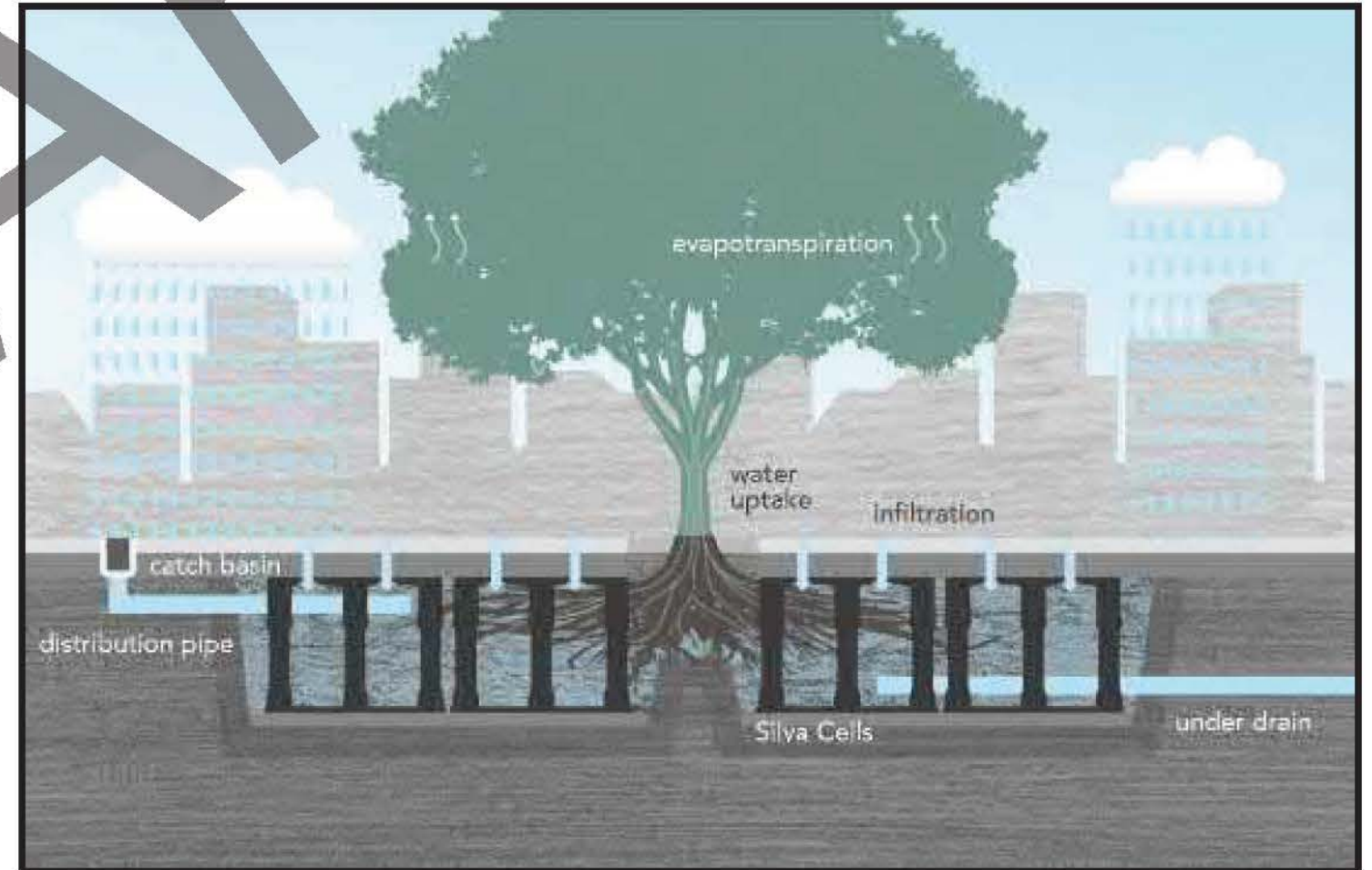

Deeproot - Silva Cells

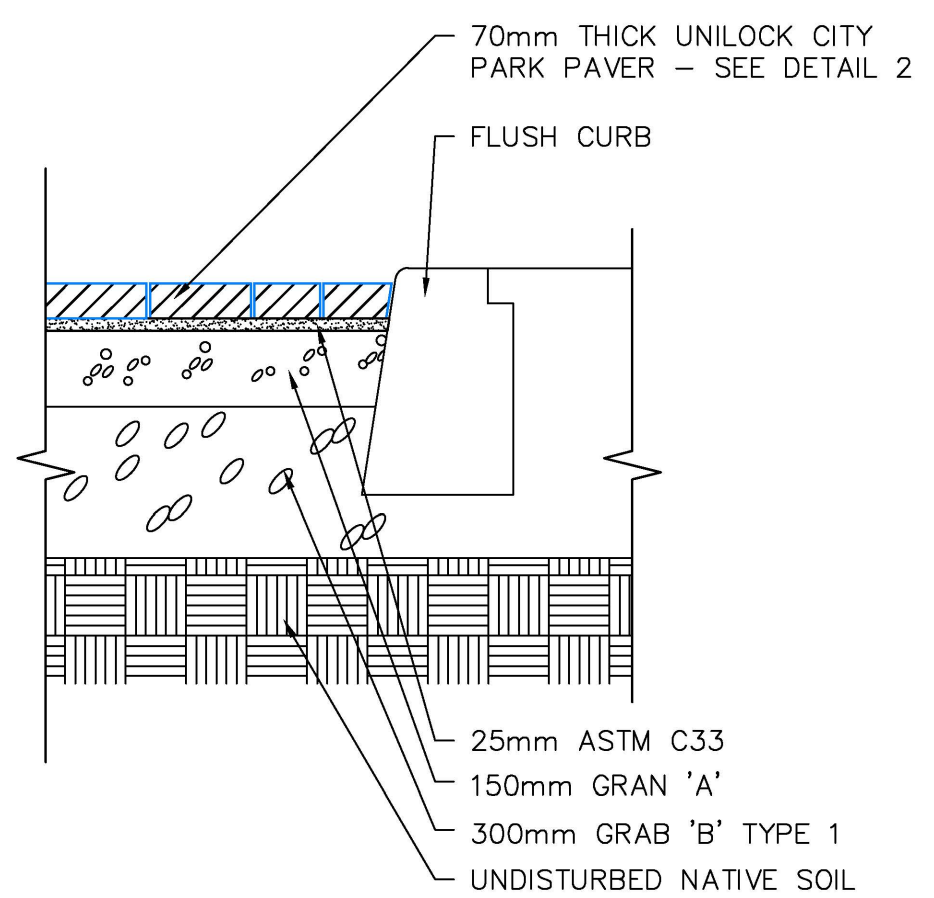

1 UNIT PAVING DETAIL  
1:15

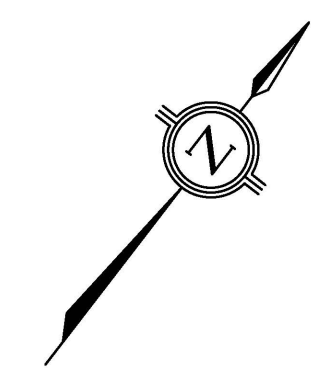
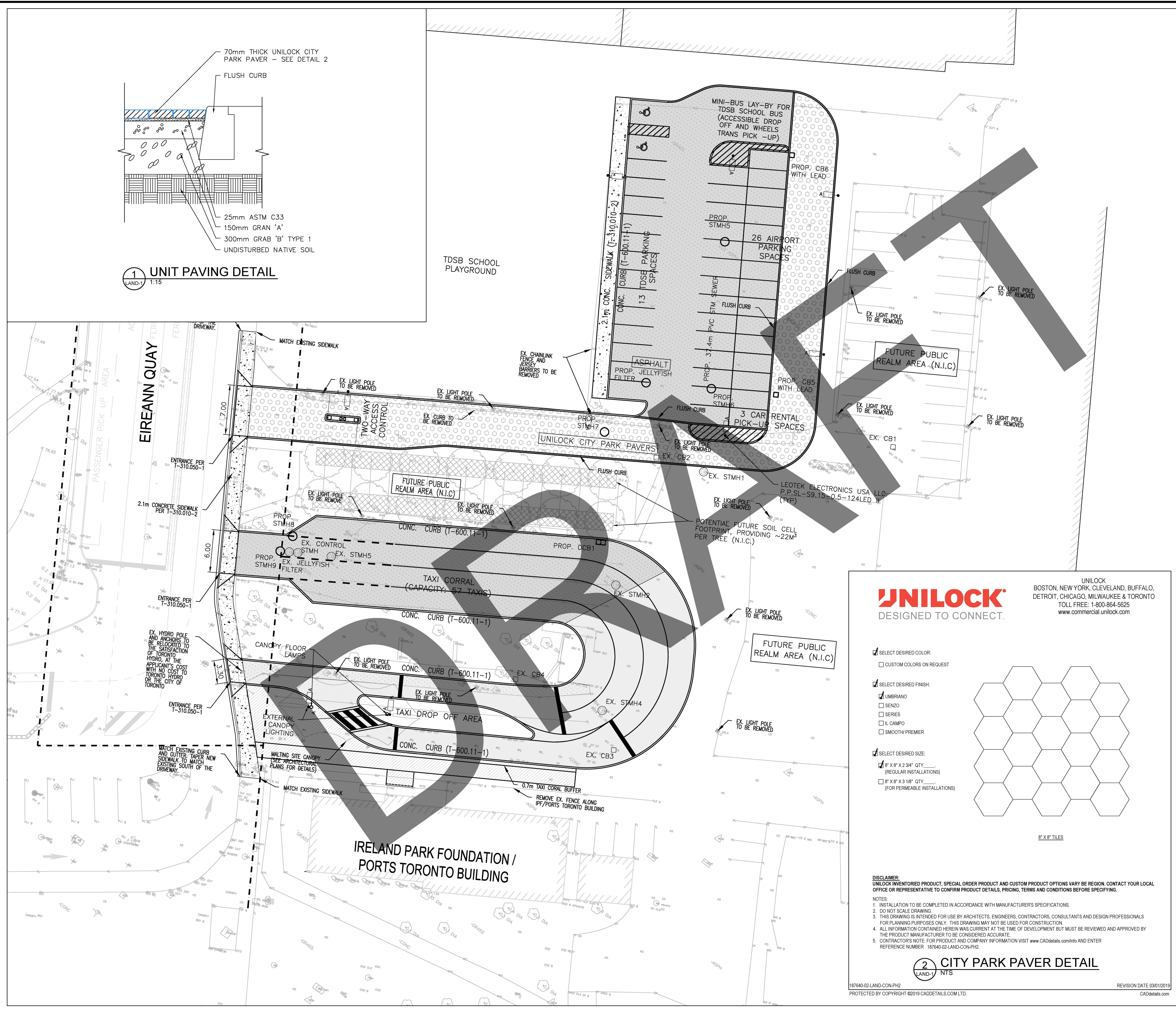

- LEGEND**
- PROPERTY LINE
  - PROPOSED TREE FOR FUTURE CONSTRUCTION
  - PROPOSED ASPHALT PAVEMENT
  - PROPOSED ASPHALT PAVEMENT FULL DEPTH PAVEMENT
  - PROPOSED UNILOCK CITY PARK PAVER FULL DEPTH PAVEMENT
  - PROPOSED TEMPORARY ASPHALT PAVEMENT
  - PROPOSED DROP CURB



FOR SUBMISSION

**BENCHMARK:**  
ELEVATIONS ARE BASED UPON VERTICLE DATUM CGVD-1928:PRE-1978 FROM THE CITY OF TORONTO BENCH MARK NO. CT1525 (STATION 12219741525). HORIZONTAL PROJECTION IS MTM-10 (NAD27).  
LOCATION: CITY OF TORONTO SOUTHEAST CORNER OF LAKESHORE BOULEVARD WEST & BATHURST STREET. BENCHMARK ON 2 STOREY BRICK BUILDING 0.3m EAST OF WEST END OF MOST NORTHERLY WALL, 0.4m ABOVE GRADE  
PUBLISHED ELEVATION = 77.341 METRES.

No.	DATE	REVISIONS	INITIAL	SIGNED
2	03/04/19	ISSUED FOR SITE PLAN APPROVAL	JDA	PAM
1	01/14/19	ISSUED FOR 30% SUBMISSION	JDA	PAM

**UNILOCK**  
DESIGNED TO CONNECT.  
UNILOCK BOSTON, NEW YORK, CLEVELAND, BUFFALO, DETROIT, CHICAGO, MILWAUKEE & TORONTO  
TOLL FREE: 1-800-864-5625  
www.commercial.unilock.com

- SELECT DESIRED COLOR:
  - CUSTOM COLORS ON REQUEST
- SELECT DESIRED FINISH:
  - UMBRIANO
  - SENZO
  - SERIES
  - IL CAMPO
  - SMOOTH PREMIER
- SELECT DESIRED SIZE:
  - 6" X 6" X 2.34" QTY (REGULAR INSTALLATIONS)
  - 6" X 6" X 3.18" QTY (FOR PERMEABLE INSTALLATIONS)

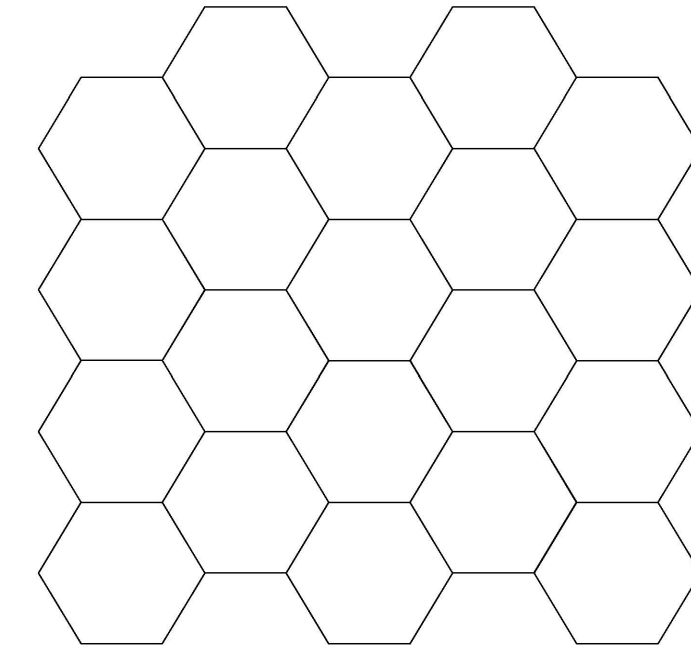

**DISCLAIMER:**  
UNILOCK INVENTORIED PRODUCT, SPECIAL ORDER PRODUCT AND CUSTOM PRODUCT OPTIONS VARY BY REGION. CONTACT YOUR LOCAL OFFICE OR REPRESENTATIVE TO CONFIRM PRODUCT DETAILS, PRICING, TERMS AND CONDITIONS BEFORE SPECIFYING.

**NOTES:**

- INSTALLATION TO BE COMPLETED IN ACCORDANCE WITH MANUFACTURER'S SPECIFICATIONS.
- DO NOT SCALE DRAWING.
- THIS DRAWING IS INTENDED FOR USE BY ARCHITECTS, ENGINEERS, CONTRACTORS, CONSULTANTS AND DESIGN PROFESSIONALS FOR PLANNING PURPOSES ONLY. THIS DRAWING MAY NOT BE USED FOR CONSTRUCTION.
- ALL INFORMATION CONTAINED HEREIN WAS CURRENT AT THE TIME OF DEVELOPMENT AND MUST BE REVIEWED AND APPROVED BY THE PRODUCT MANUFACTURER TO BE CONSIDERED ACCURATE.
- CONTRACTOR'S NOTE: FOR PRODUCT AND COMPANY INFORMATION VISIT [www.CADDetails.com/info](http://www.CADDetails.com/info) AND ENTER REFERENCE NUMBER: 187640-02-LAND-CON-PH2

2 CITY PARK PAVER DETAIL  
LAND-1 NTS

PLANNING & DESIGN SERVICES INC. 2018 ONTARIO REG. NO. 123456789. 187640-02-LAND-CON-PH2. LAND-1. PLOTTED BY: AMATO, JOSEPH. DATE: 2019-03-11. SCALE: 1:250. SITE: 187640-02-LAND-CON-PH2.

**DILLON CONSULTING**  
51 Breithaupt Street, Suite 200,  
Kitchener, ON N2H 5G5  
Phone: (519) 571-9833  
Fax: (519) 571-7424

**PORTS TORONTO**

BILLY BISHOP AIRPORT  
CITY SIDE MODERNIZATION PROJECT:  
MALTING SITE IMPROVEMENTS  
PROPOSED LANDSCAPE AND LIGHTING PLAN

DESIGN	JTG	DRAWN	JTG	CHECKED		JOB No. 18-7640
SCALE:	1:250		DWG:		LAND-1	
DATE:	FEBRUARY 2019		SHEET		9 OF 20	

LITTLE NORWAY PARK

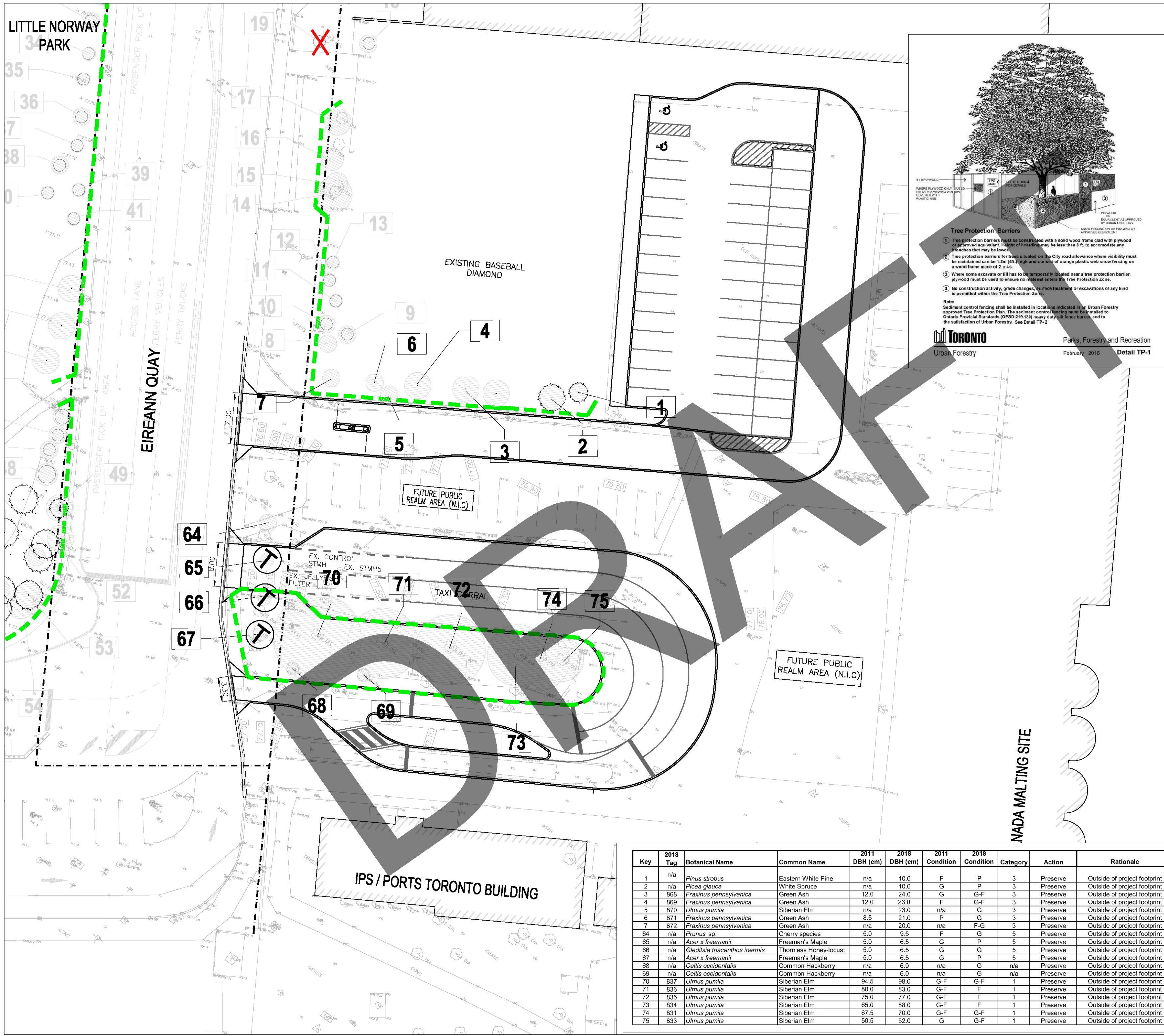

**Tree Protection Barriers**

- Tree protection barriers must be constructed with a solid wood frame clad with plywood or approved equivalent. Height of hoarding may be less than 8 ft. to accommodate any branches that may be lower.
- Tree protection barriers for trees situated on the City road allowance where visibility must be maintained can be 12m (4ft.) high and consist of orange plastic web snow fencing on a wood frame made of 2 x 4s.
- Where some excavate or fill has to be temporarily located near a tree protection barrier, plywood must be used to ensure no material enters the Tree Protection Zone.
- No construction activity, grade changes, surface treatment or excavations of any kind is permitted within the Tree Protection Zone.

Note:  
Sediment control fencing shall be installed in locations indicated in the Urban Forestry approved Tree Protection Plan. The sediment control fencing must be related to Ontario Provincial Standards (OPS-215.13) heavy duty roll fence bank, and to the satisfaction of Urban Forestry. See Detail TP-2.

**Toronto** Parks, Forestry and Recreation  
Urban Forestry February, 2016 Detail TP-1

**LEGEND**

- PROPERTY LINE
- 72 TREE INVENTORY KEY
- TREE PROTECTION ZONE
- ⊕ TREE TO BE TRANSPLANTED
- ✗ TREE TO BE REMOVED
- TREE PROTECTION FENCING PER TP-1



FOR SUBMISSION

**BENCHMARK:**  
ELEVATIONS ARE BASED UPON VERTICLE DATUM CGVD-1928:PRE-1978 FROM THE CITY OF TORONTO BENCH MARK NO. CT1525 (STATION 12219741525). HORIZONTAL PROJECTION IS MTM-10 (NAD27).  
LOCATION: CITY OF TORONTO SOUTHEAST CORNER OF LAKESHORE BOULEVARD WEST & BATHURST STREET. BENCHMARK ON 2 STOREY BRICK BUILDING 0.3m EAST OF WEST END OF MOST NORTHERLY WALL, 0.4m ABOVE GRADE  
PUBLISHED ELEVATION = 77.341 METRES.

No.	DATE	REVISIONS	INITIAL	SIGNED
2	03/04/19	ISSUED FOR SITE PLAN APPROVAL	JDA	PAM
1	01/14/19	ISSUED FOR 30% SUBMISSION	JDA	PAM

**DILLON CONSULTING**  
51 Brantlough Street, Suite 200, Kitchener, ON N2H 5G5  
Phone: (519) 571-9833  
Fax: (519) 571-7424

**REGISTERED PROFESSIONAL ENGINEER**  
P. A. MacLEOD  
2019/02/22  
PROVINCE OF ONTARIO

**PORTS TORONTO**

**BILLY BISHOP AIRPORT  
CITY SIDE MODERNIZATION PROJECT:  
MALTING SITE IMPROVEMENTS  
TREE PRESERVATION PLAN**

DESIGN	JDA	DRAWN	AZ	CHECKED	JOB No. 18-7640
SCALE:	1:250	DWG:	TPP-1		
DATE:	FEBRUARY 2019	SHEET	10 OF 20		

Key	2018 Tag	Botanical Name	Common Name	2011 DBH (cm)	2018 DBH (cm)	2011 Condition	2018 Condition	Category	Action	Rationale	TPZ (m)
1	n/a	<i>Pinus strobus</i>	Eastern White Pine	n/a	10.0	F	P	3	Preserve	Outside of project footprint	1.8
2	n/a	<i>Picea glauca</i>	White Spruce	n/a	10.0	G	P	3	Preserve	Outside of project footprint	1.8
3	868	<i>Fraxinus pennsylvanica</i>	Green Ash	12.0	24.0	G	G-F	3	Preserve	Outside of project footprint	2.4
4	869	<i>Fraxinus pennsylvanica</i>	Green Ash	12.0	23.0	F	G-F	3	Preserve	Outside of project footprint	2.4
5	870	<i>Ulmus pumila</i>	Siberian Elm	n/a	23.0	n/a	G	3	Preserve	Outside of project footprint	2.4
6	871	<i>Fraxinus pennsylvanica</i>	Green Ash	8.5	21.0	P	G	3	Preserve	Outside of project footprint	2.4
7	872	<i>Fraxinus pennsylvanica</i>	Green Ash	n/a	20.0	n/a	F-G	3	Preserve	Outside of project footprint	2.4
64	n/a	<i>Prunus sp.</i>	Cherry species	5.0	9.5	F	G	5	Preserve	Outside of project footprint	1.8
65	n/a	<i>Acer x freemanii</i>	Freeman's Maple	5.0	6.5	G	P	5	Preserve	Outside of project footprint	1.8
66	n/a	<i>Glottisia tricanthos inermis</i>	Thornless Honey-Locust	5.0	6.5	G	P	5	Preserve	Outside of project footprint	1.8
67	n/a	<i>Acer x freemanii</i>	Freeman's Maple	5.0	6.5	G	P	5	Preserve	Outside of project footprint	1.8
68	n/a	<i>Celtis occidentalis</i>	Common Hackberry	n/a	6.0	n/a	G	n/a	Preserve	Outside of project footprint	1.8
69	n/a	<i>Celtis occidentalis</i>	Common Hackberry	n/a	6.0	n/a	G	n/a	Preserve	Outside of project footprint	1.8
70	837	<i>Ulmus pumila</i>	Siberian Elm	94.5	98.0	G-F	G-F	1	Preserve	Outside of project footprint	6
71	836	<i>Ulmus pumila</i>	Siberian Elm	80.0	83.0	G-F	F	1	Preserve	Outside of project footprint	5.4
72	835	<i>Ulmus pumila</i>	Siberian Elm	75.0	77.0	G-F	F	1	Preserve	Outside of project footprint	4.8
73	834	<i>Ulmus pumila</i>	Siberian Elm	65.0	68.0	G-F	F	1	Preserve	Outside of project footprint	4.2
74	831	<i>Ulmus pumila</i>	Siberian Elm	67.5	70.0	G-F	G-F	1	Preserve	Outside of project footprint	4.2
75	833	<i>Ulmus pumila</i>	Siberian Elm	50.5	52.0	G	G-F	1	Preserve	Outside of project footprint	3.6

DRAWN BY: J. BISHOP, CHECKED BY: J. BISHOP, DATE: 02/14/19, PROJECT: BILLY BISHOP AIRPORT, CITY SIDE MODERNIZATION PROJECT, MALTING SITE IMPROVEMENTS, TREE PRESERVATION PLAN, SHEET 10 OF 20, PLOT DATE: 02/14/19, PLOT SCALE: 1:250, PLOT BY: J. BISHOP, PLOT NO: 18-7640-TPP-1