

Queens Quay Working Group Meeting #3

September 21, 2010

Agenda

1. Introduction and report back
Pino Di Mascio, Urban Strategies Inc.
2. Intersection design follow up
Jelle Therry and Adam Nicklin, West 8 + DTAH
3. Introduction to bus inventory analysis
Alun Lloyd, BA Group
4. Streetscape design break-out discussion
Jelle Therry and Adam Nicklin, West 8 + DTAH
5. 2 month outlook
Jelle Therry, West 8 + DTAH
6. Next steps
Pino Di Mascio, Urban Strategies Inc.

Working Schedule

WORKING GROUP MEETING		SAMPLE AGENDA ITEMS
1	July 20, 2010	<ul style="list-style-type: none"> • Queens Quay Working Group Terms of Reference, membership and work plan • Overview of public engagement process • Overview and design update • Update on phasing • 2 month outlook
2	August 24, 2010	<ul style="list-style-type: none"> • Walking tour
3	September 21, 2010	<ul style="list-style-type: none"> • Intersection design • Streetscape design • Overview of bus inventory analysis
4	October 19, 2010	<ul style="list-style-type: none"> • Streetscape design • Street furnishing and accessory sitting • Phasing • Bus management strategy/dedicated bus and truck routes
5	November 23, 2010	<ul style="list-style-type: none"> • Introduction to wayfinding and signage • Accessibility • Introduction construction management
6	December 21, 2010 (tentative)	<ul style="list-style-type: none"> • Traffic planning • Energy demand/event electrical plan
7	January 18, 2011	<ul style="list-style-type: none"> • Construction Liaison Committee scope and Terms of Reference
8	February 15, 2011	
9	March 22, 2011	
10	April 19, 2011	
11	May 24, 2011	
12	June 21, 2011	

QUEENS QUAY



Design Update
2010.09.21 Queens Quay Working Group Meeting 3
Presentation

West 8 + DTAH

CONTENTS

Typical intersection

Streetscaping - landscaping

2 months outlook

INTERSECTION DESIGN



Typical intersection
Working group meeting 17.08.2010

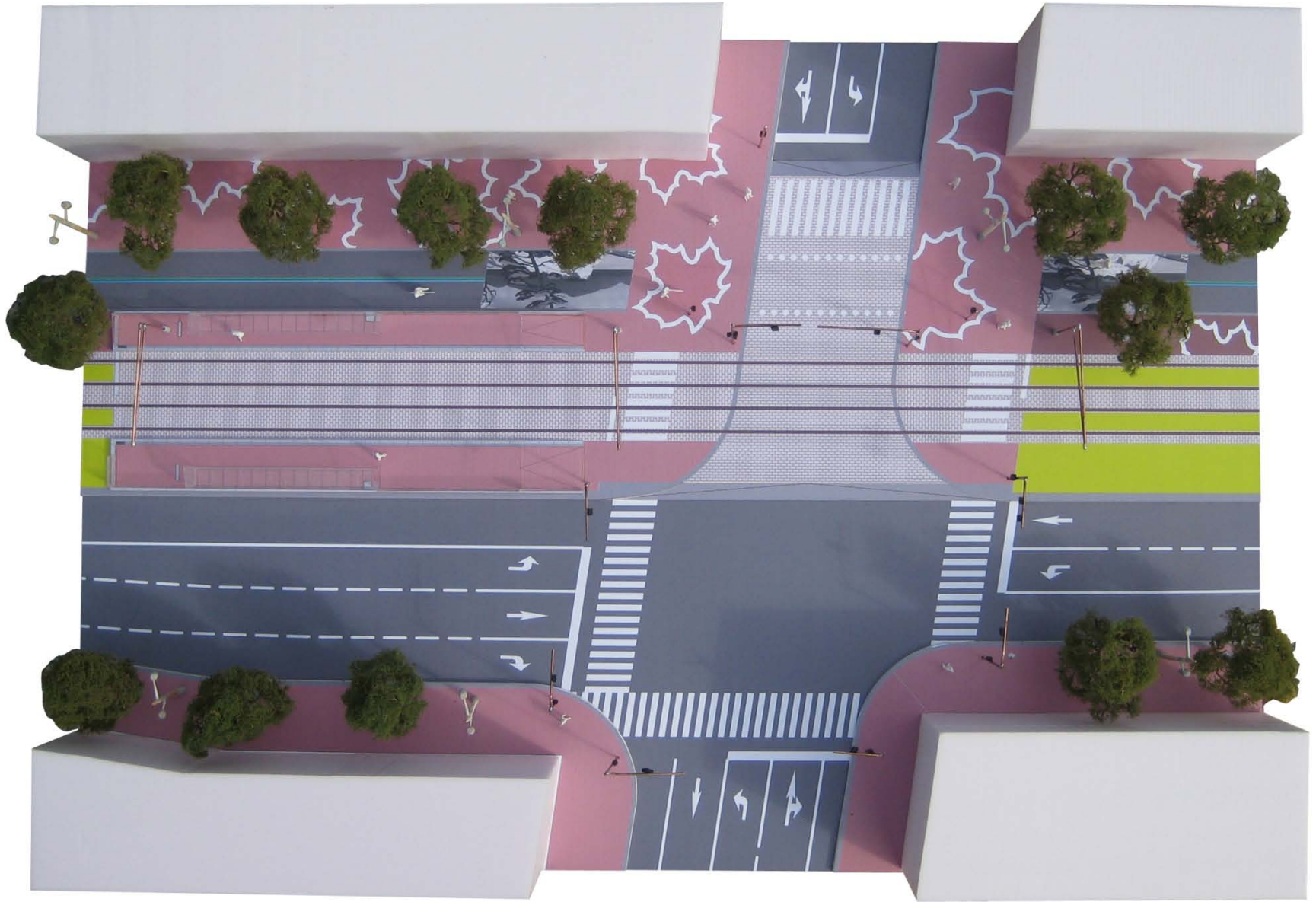



Typical intersection
Meeting with transportation staff city, 02.09.2010

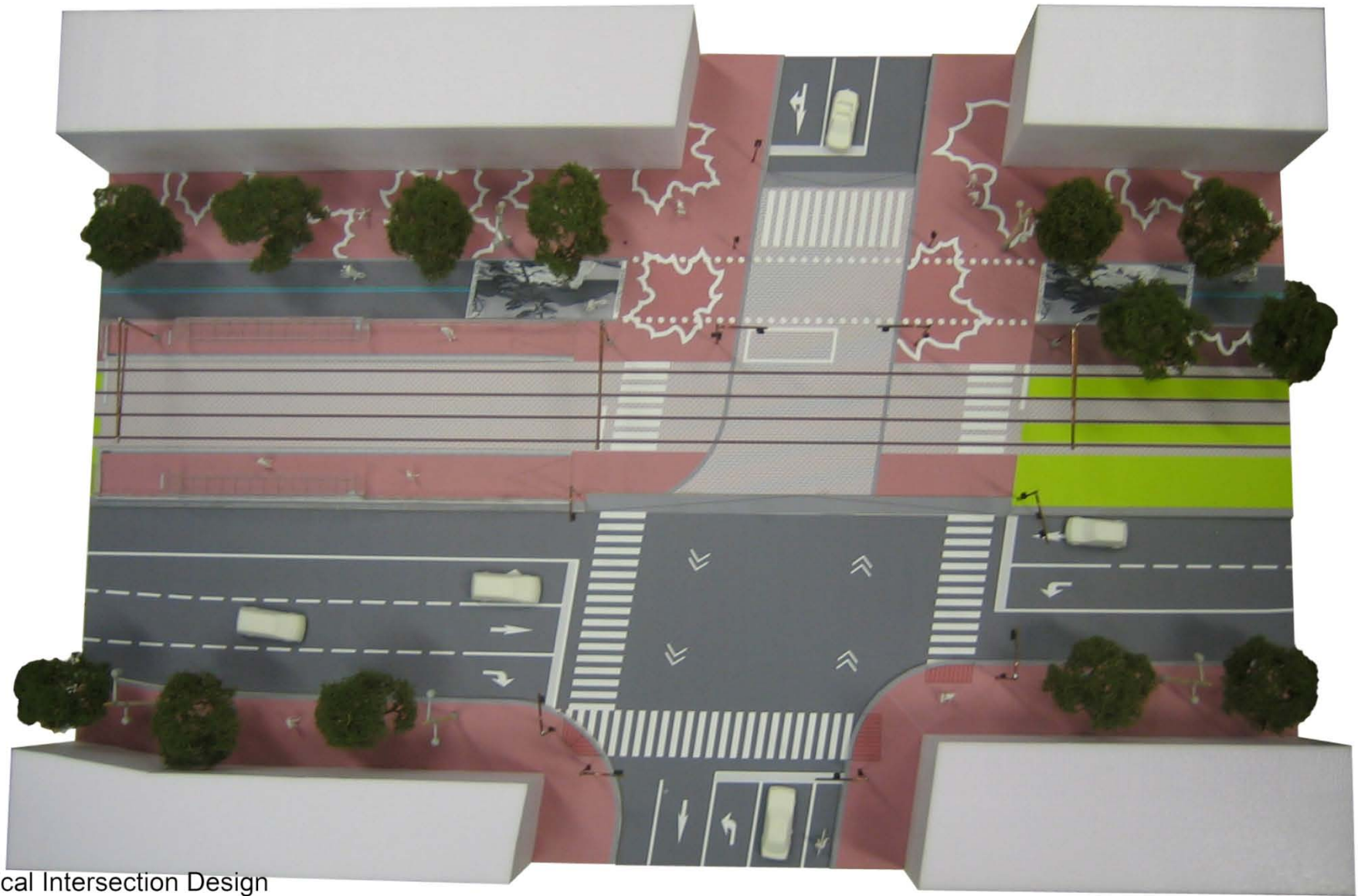

Typical Intersection Design
September 2th, 2010

- Traffic Pole
- ^{PP} Pedestrian Pole
- ^{TR} Transit Signal
- ←+ Signal Head
- Pedestrian Signal Head
- Bike Signal Head (green ball)

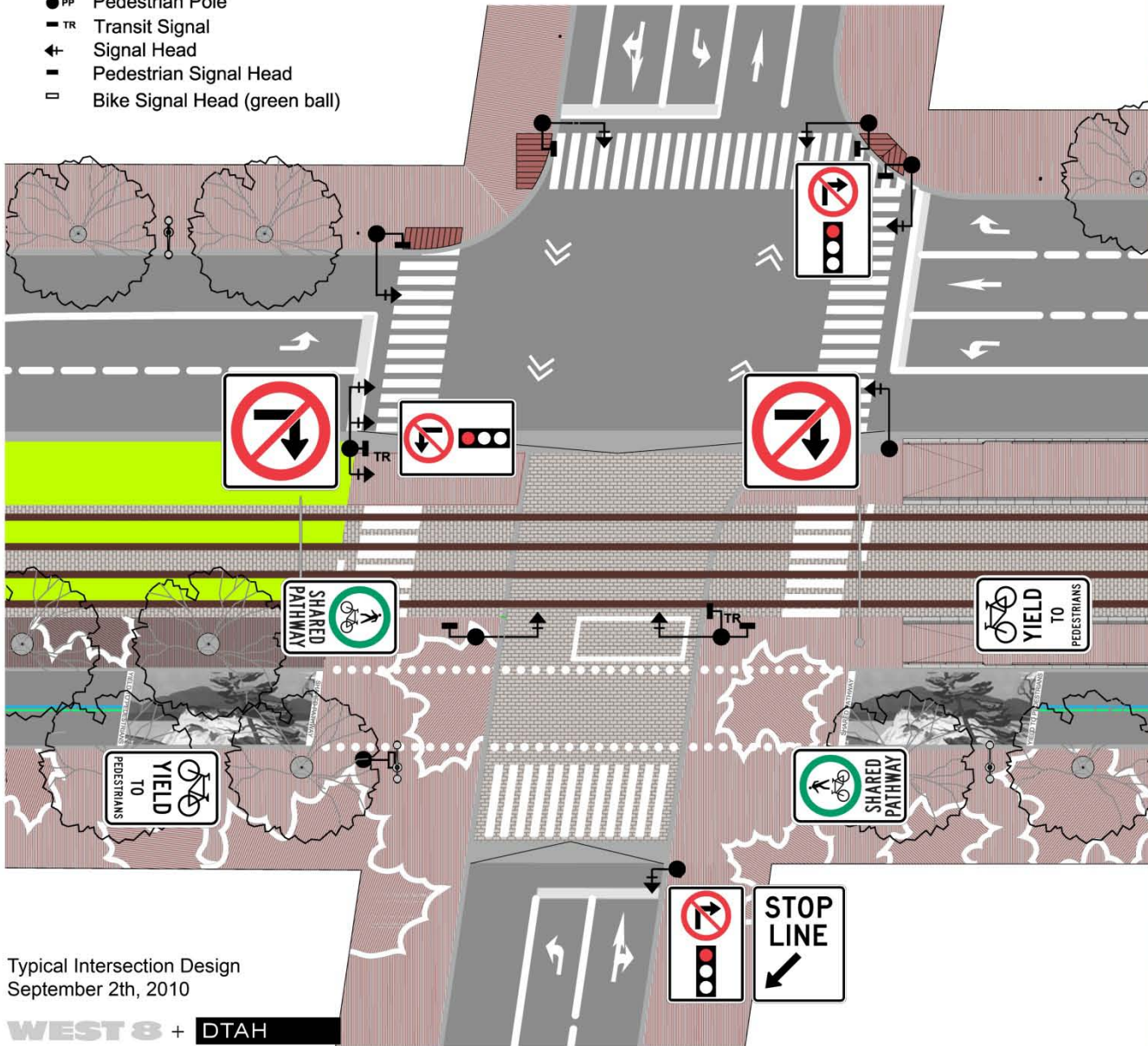

Typical Intersection Design
September 2th, 2010

WEST 8 + DTAH

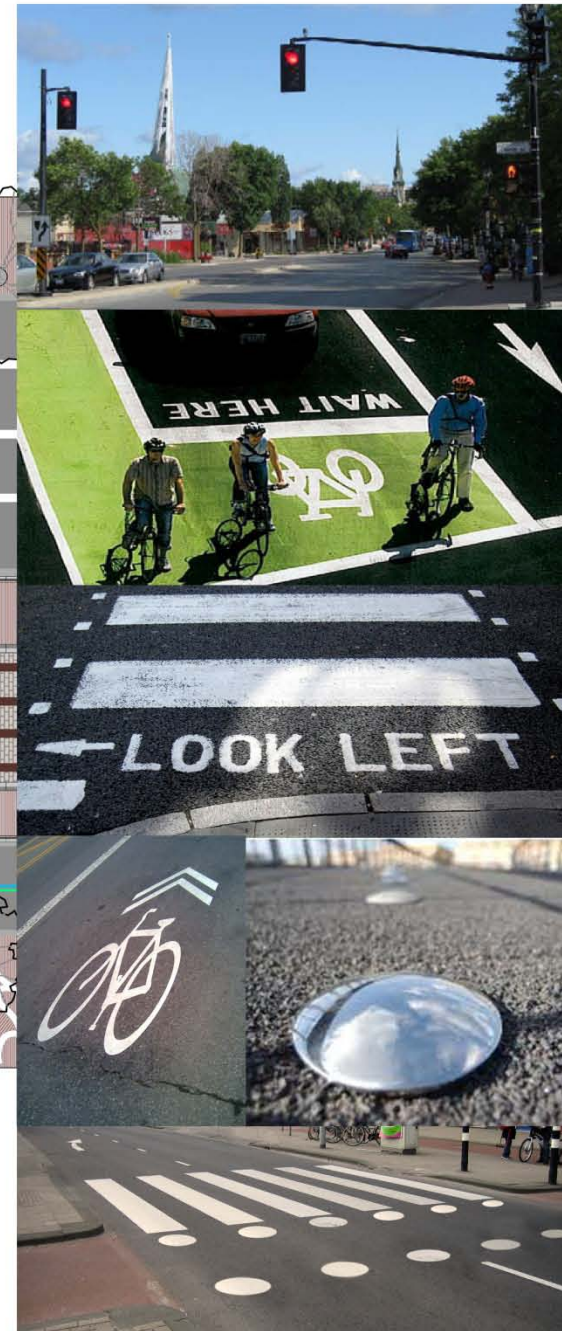

Typical intersection
 Working group meeting 21.09.2010

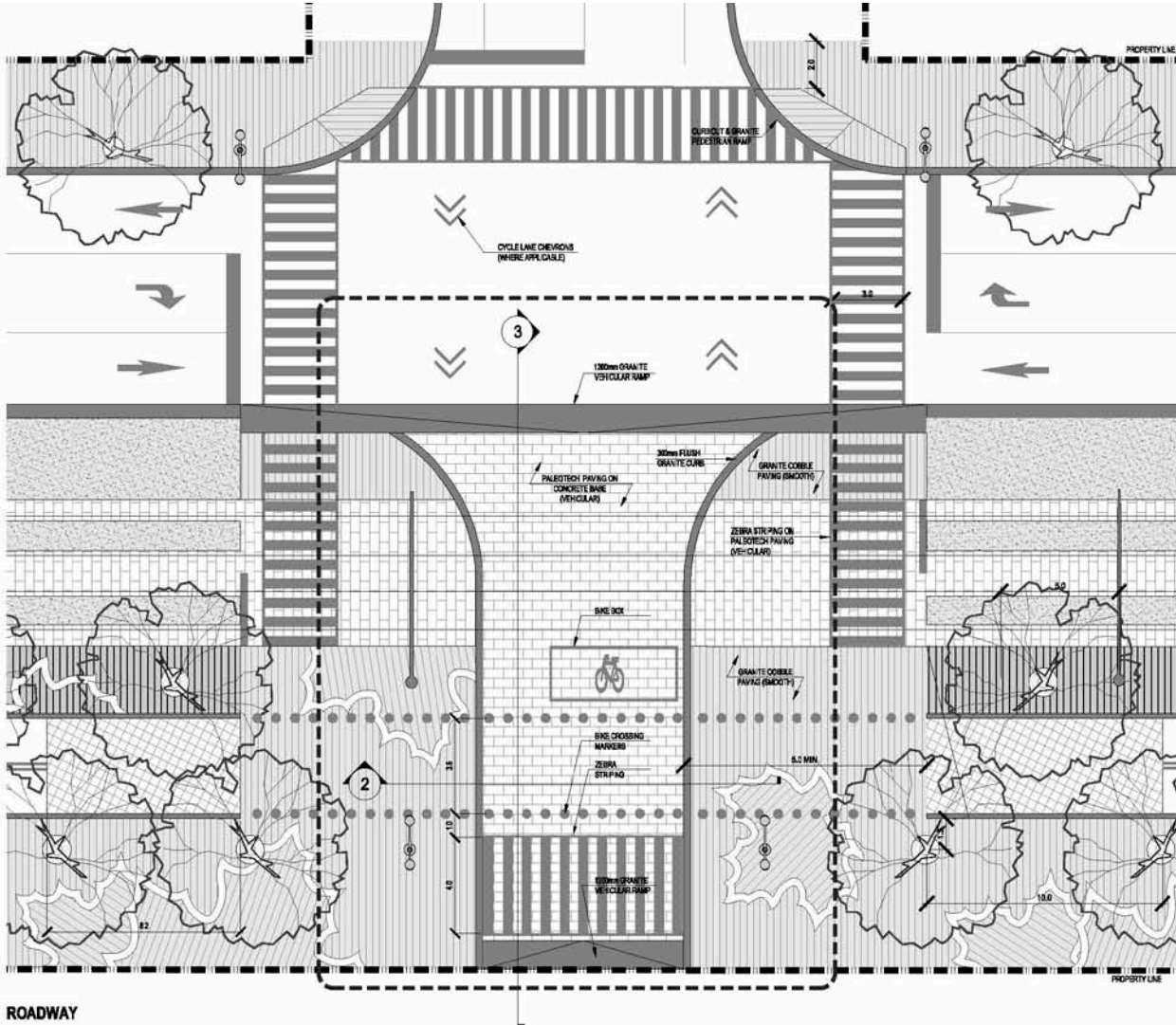

ROADWAY

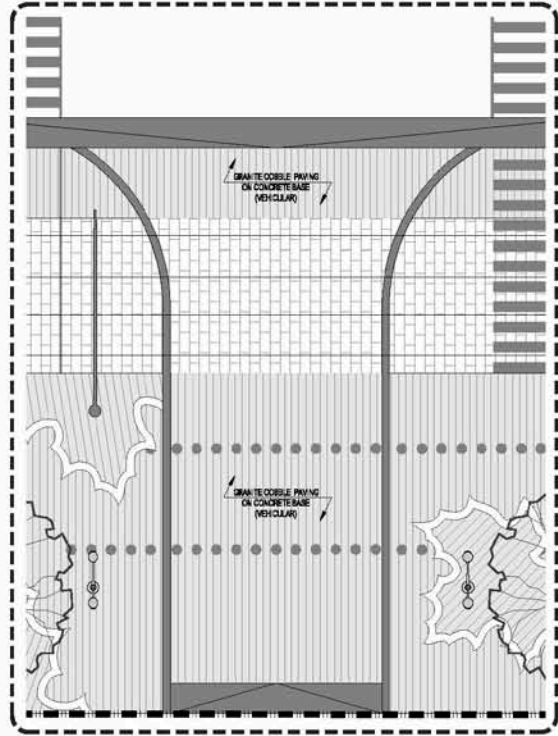

DRIVEWAY - AS ROADWAY EXCEPT

- Traffic Pole
- ^{TR} Transit Signal
- ⬆ Signal Head
- ⬆ Pedestrian Signal Head
- Bike and Pedestrian Signal Head (green ball incl. countdown)

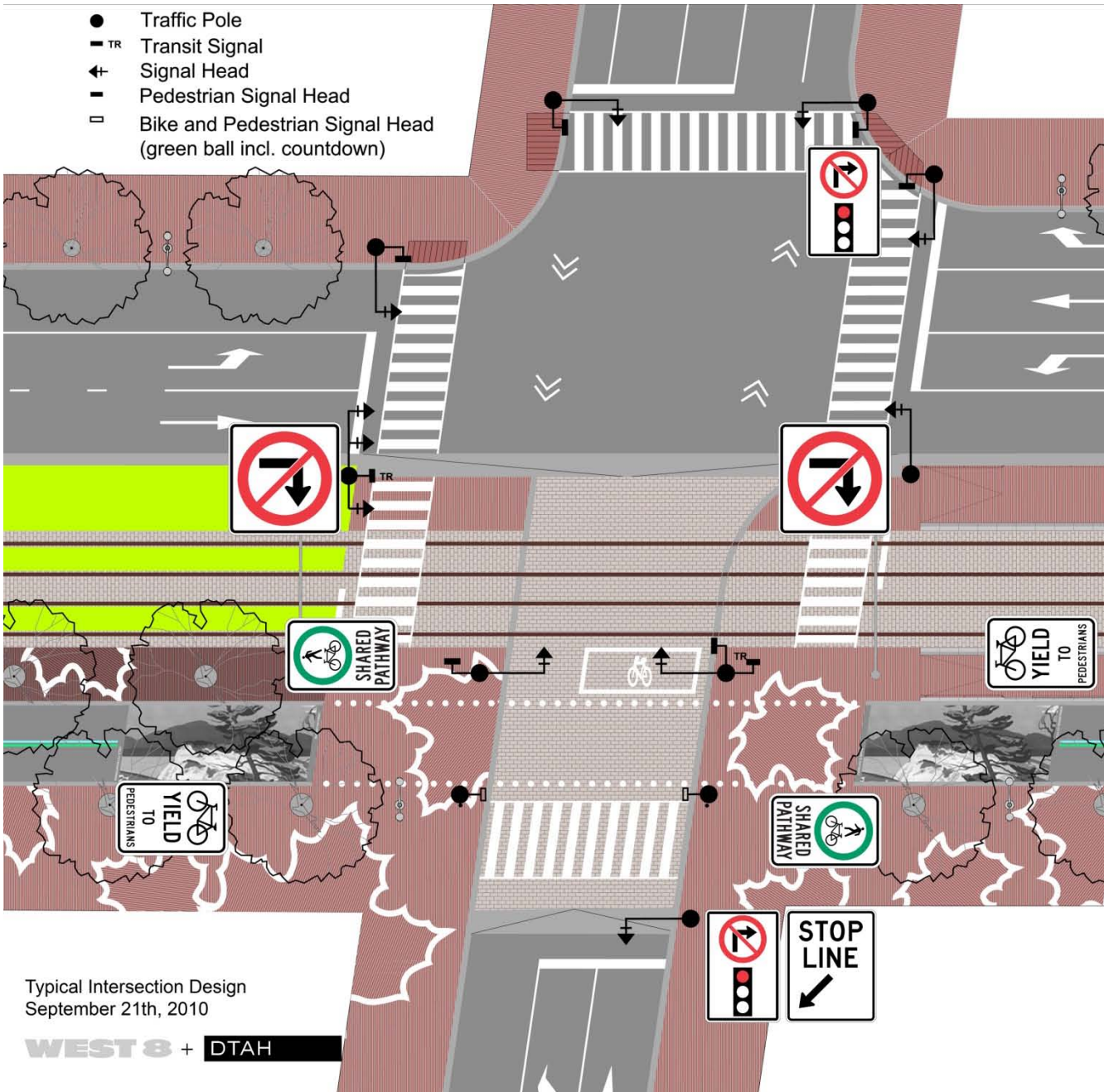

Typical Intersection Design
September 21th, 2010

Illustration



STREETSCAPING AND LANDSCAPING

Typical cross section

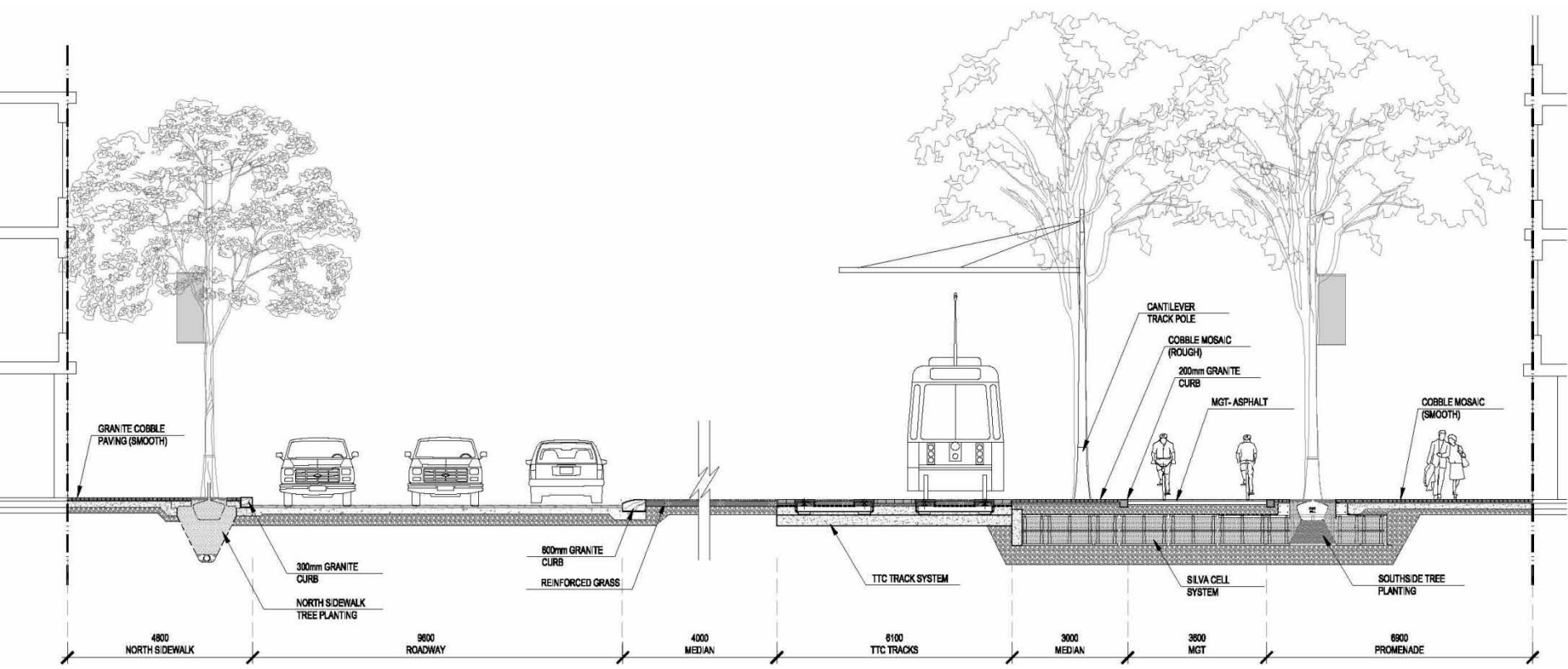

Midblock section

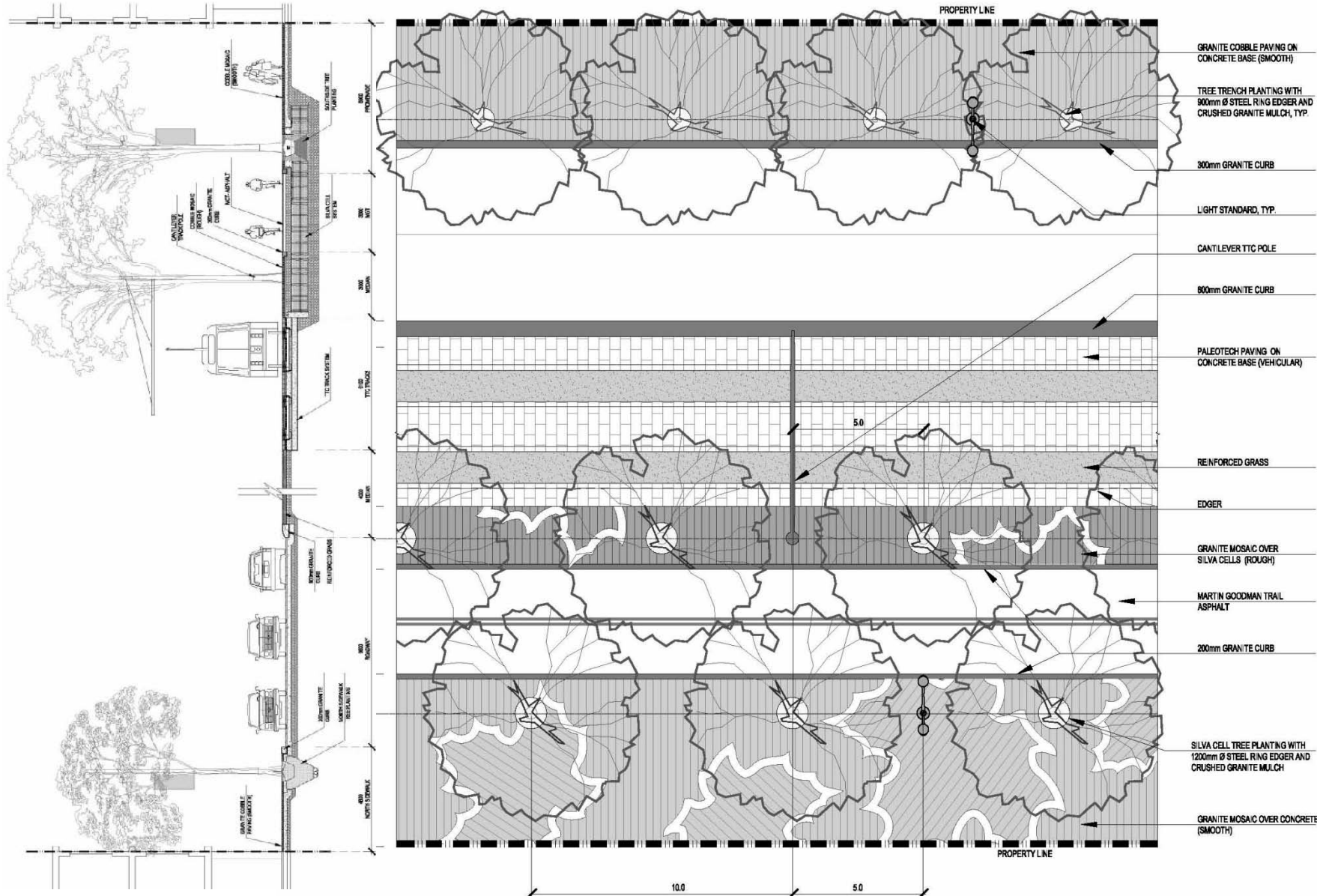

Northside

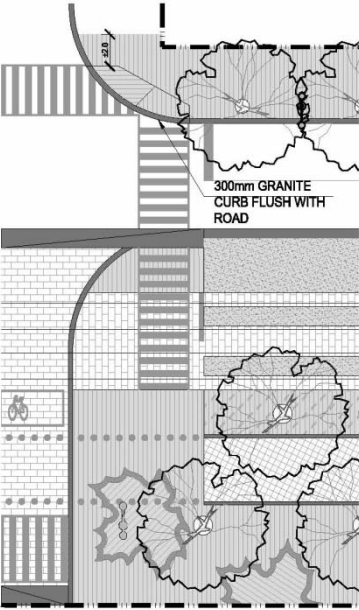

INTERSECTION

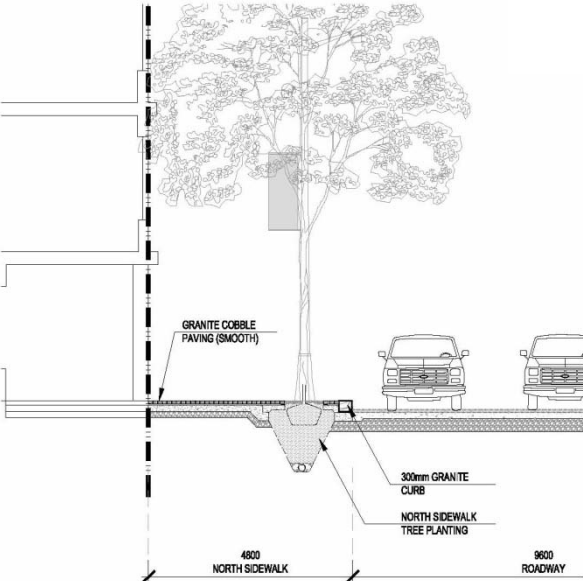

TYPICAL SECTION

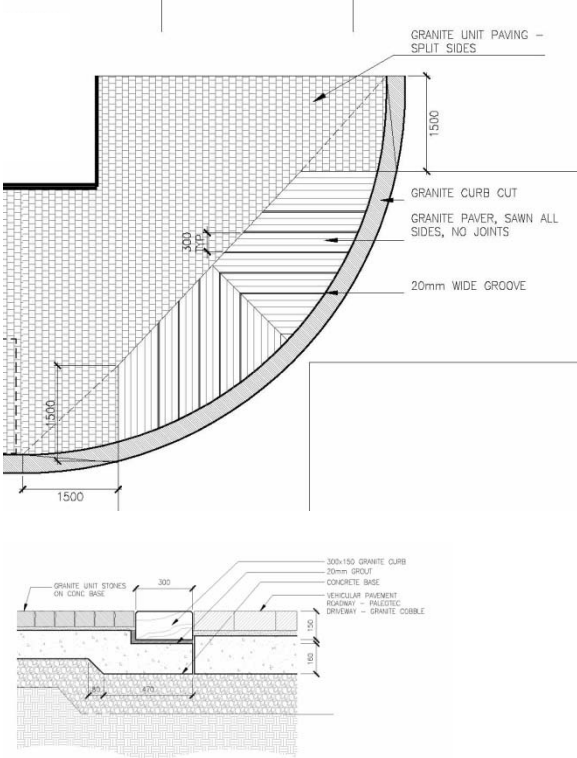

Northside

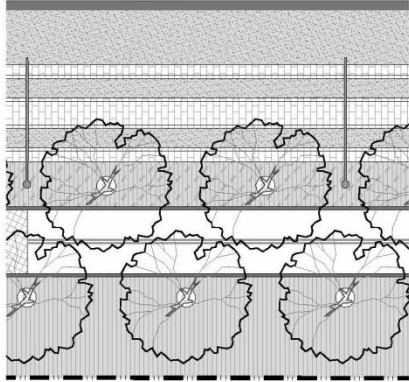
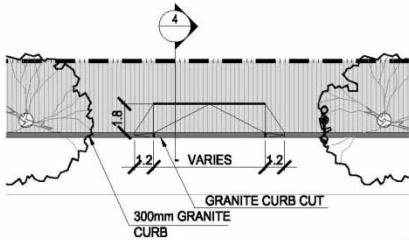

DRIVEWAY

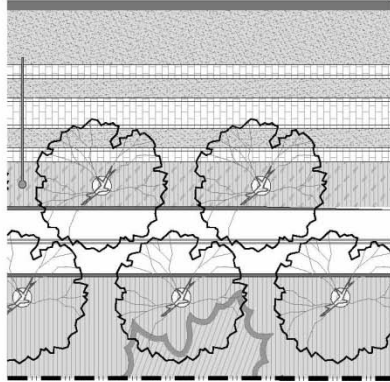
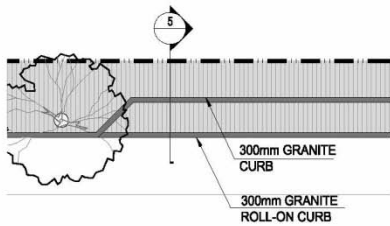

LAYBY

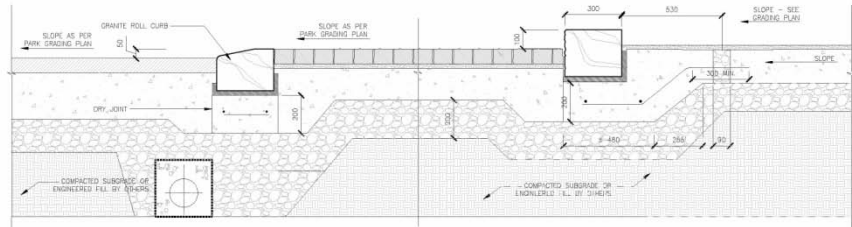

Southside

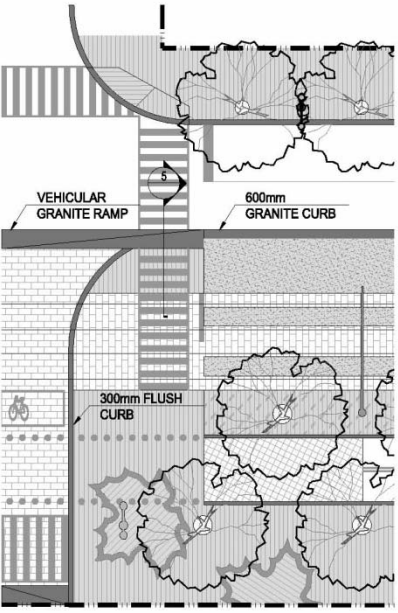

TYPICAL

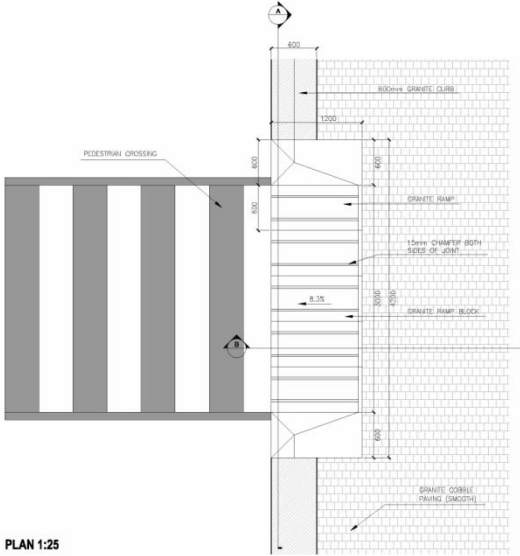
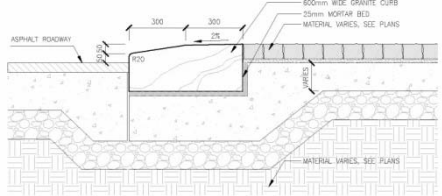
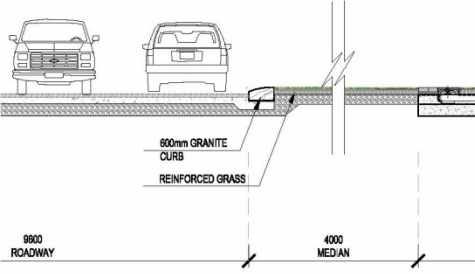

PLAN 1:25

Southside

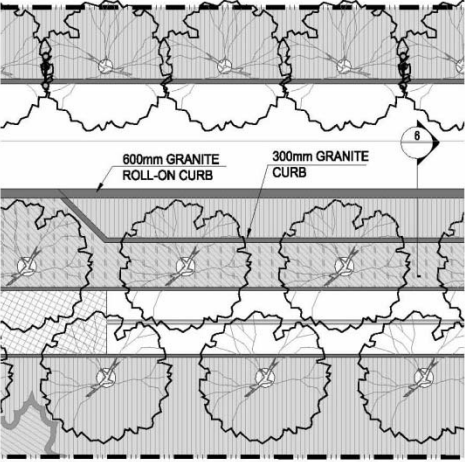

LAYBY AT WESTIN

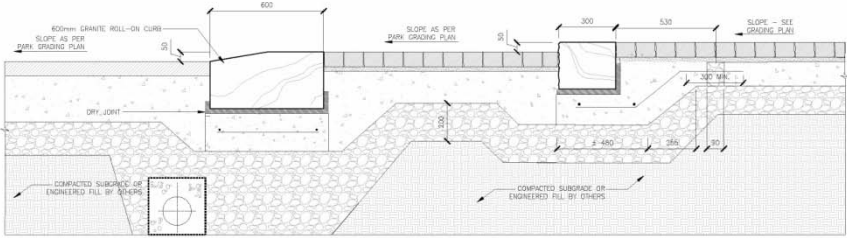

Design Elements

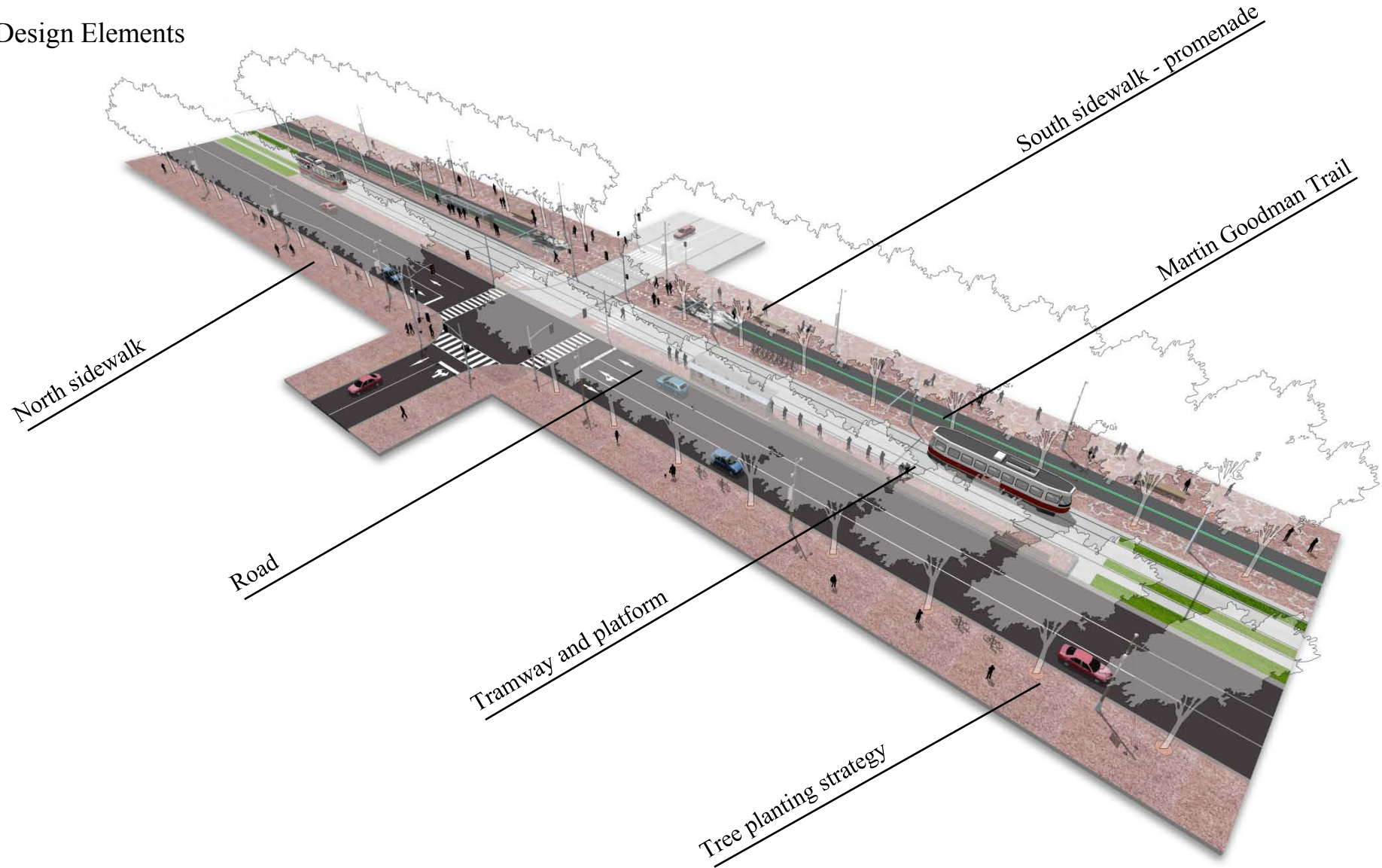

North sidewalk

Road

Tramway and platform

Tree planting strategy

South sidewalk - promenade

Martin Goodman Trail

Two Month Outlook

- 100% Schematic Design –submission to the city
- Start Definitive Design – linear park and phase 1
- Wayfinding / signage
- Heritage and Art strategy
- Accessibility
- Bus management

Next Steps

- Queens Quay Working Group Meeting # 4 scheduled for Oct. 19
- Community Update Meeting #2 scheduled for Nov. 2

<http://www.waterfrontoronto.ca/qqconsultation>